

Titus Group  
Technical Catalogue  
and Manual



# **Tekform Slimline+ Drawer**

2024



# Important Information

## Technical information

Our catalog strives for information accuracy, but as our products are continually updated, we recommend verifying the latest specifications before placing an order. We retain the right to make unannounced changes due to ongoing product improvements.

## User responsibility

Users are responsible for ensuring that our hardware suits their intended purpose. We suggest conducting appropriate tests and reaching out to our technical representatives for assessment.

## Intellectual property

Titus Group possesses global intellectual property rights, including trademarks, patents, copyrights, designs, illustrations, drawings, and the proprietary knowledge embedded in our products' design and production. We also respect competitors' rights and other relevant product design rights. Our products are not known to infringe upon any intellectual property rights, but we take infringements seriously and will vigorously defend our rights within the bounds of the law.

## Non-preferred articles

Items marked with \* in the catalog are non-preferred and may have extended delivery times.

## Trademarks

Titus and Titusonic are registered trademarks of Titus International Ltd. Lama is a registered trademark of Titus d.o.o. Dekani. WoodWelding is a registered trademark of WW SA.

# Tekform Slimline+ Drawer

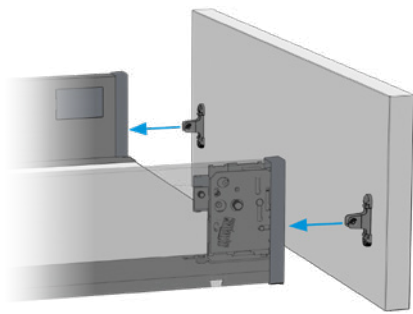
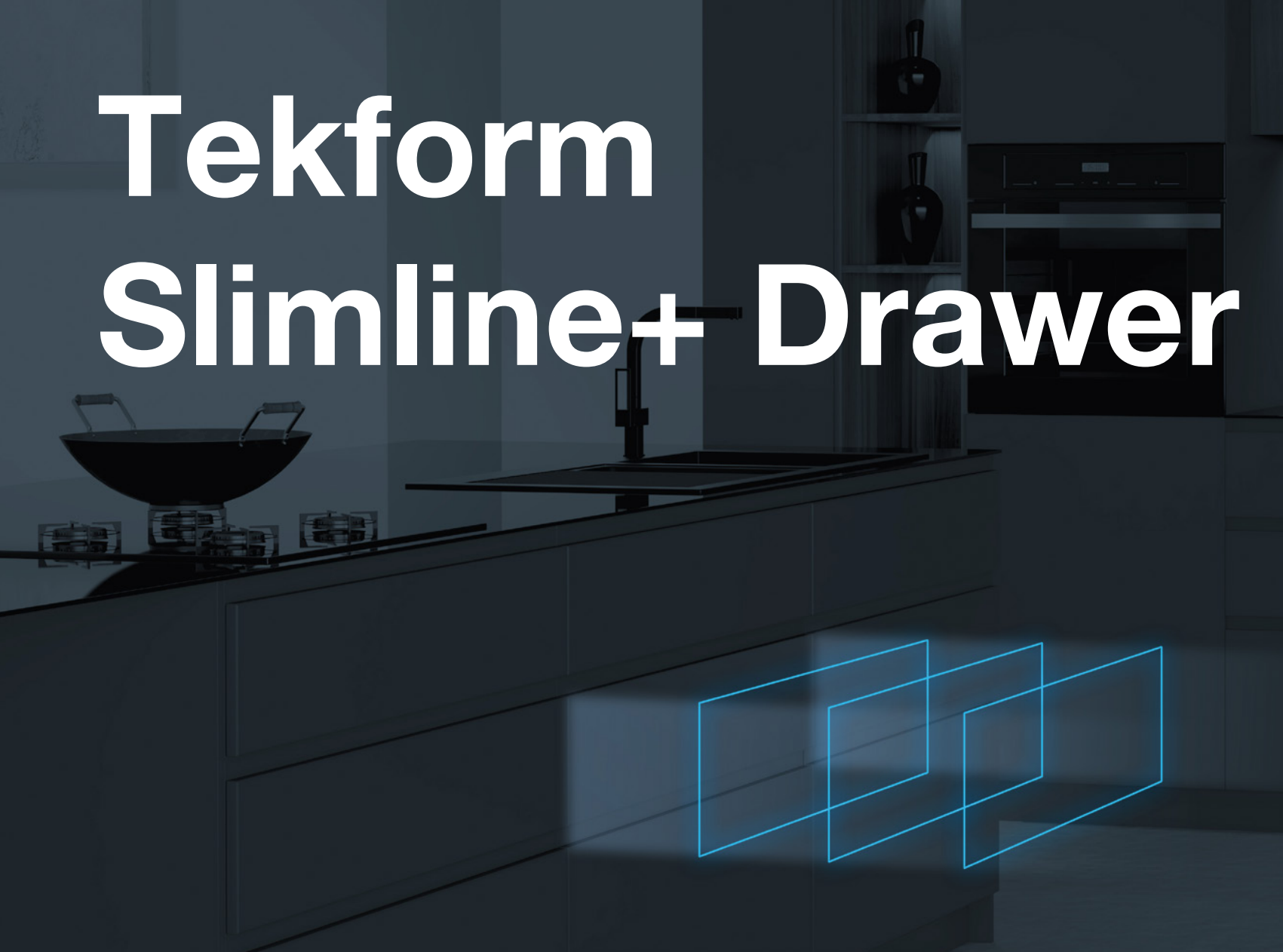

## Swift assembly with enhanced front panel engagement

- Retaining feature on the locking mechanism ensures secure and reliable front panel engagement
- Optimised front panel connectors stabilize front panel prior to assembly
- Effortless disengagement for easy adjustments at any time

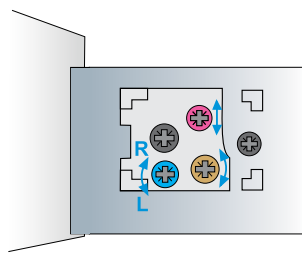

## 3D drawer front alignment with easy access

- Convenient front access for side, height, and tilt adjustment
- Colour-coded adjustment cams for easy identification
- Ensures uniform gap layouts for evenly aligned drawer fronts

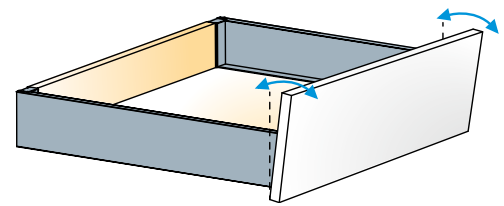

## Tilt adjustment

- Accessible at the front of the drawer side
- For an intuitive drawer front positioning through the mechanical stop



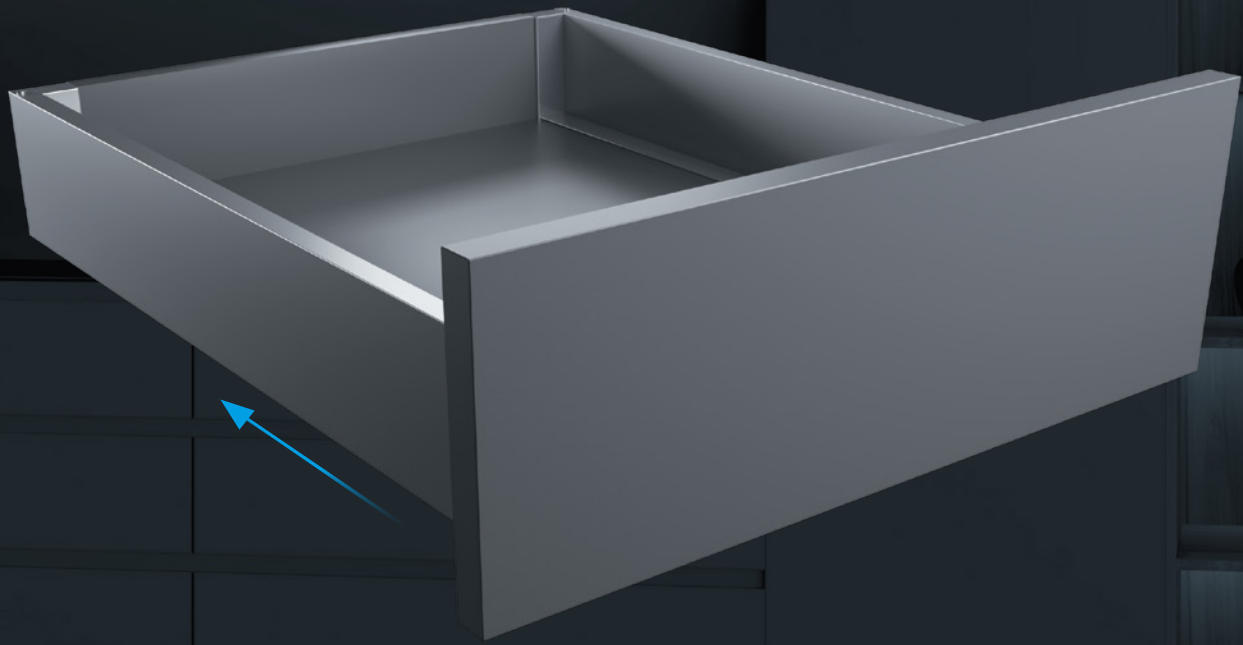

### Smooth and effortless performance

- Titus Damper Inside with ART function for smooth and controlled movement, regardless of the closing speed
- Low pull-out force
- Optimal closing performance and life-long consistent damping

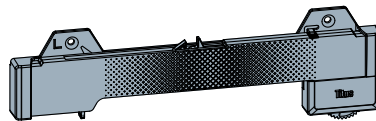

### Push-to-open compatibility for handleless cabinets

- Intuitive mounting without pre-drilling
- One-for-all: one mechanism for all Tekform Slimline+ drawers from 300mm onwards
- Easily adjustable push-to-open activation with only 1.5mm gap to operate
- Same runner for standard and push-to-open application

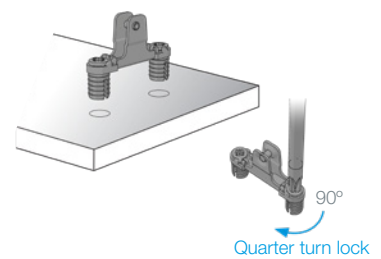

### EasyFix front panel attachment

- Simple hand insertion
- Comfortable locking action at 90° turn of screwdriver
- Expando function for firm and reliable front attachment

# Tekform Slimline+ Drawer

## Product Guide

Page

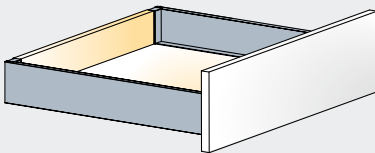
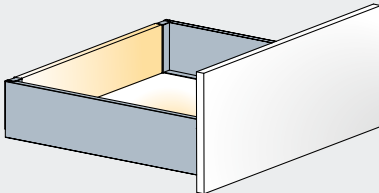
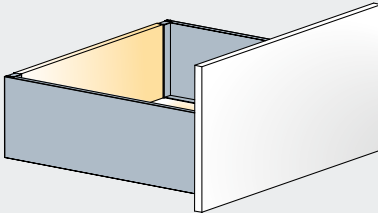
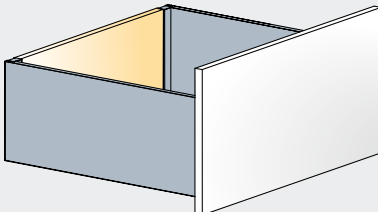
Tekform Slimline+ Drawer		Side material	Drawer type	
Tekform Slimline+ drawer DW70		Metal	Soft closing Push-to-open compatible	1.11
Tekform Slimline+ drawer DW100		Metal	Soft closing Push-to-open compatible	1.13
Tekform Slimline+ drawer DW145		Metal	Soft closing Push-to-open compatible	1.15
Tekform Slimline+ drawer DW182		Metal	Soft closing Push-to-open compatible	1.17

## Accessories

Tacto push opening mechanism 1.19

Steel back panel 1.21



# Tekform Slimline+ Drawer Information

## Technical Guide

### How to choose the appropriate drawer dimension?

Select the drawer size based on the available cabinet space. Please refer to the chart below, which indicates the

minimum space required in the cabinet to choose the appropriate drawer system.

NL = Tekform Slimline+ drawer nominal length (mm)

NL	270	300	350	400	450	500	550
----	-----	-----	-----	-----	-----	-----	-----

	Tekform Slimline+ drawer	
	Min. height H required	Cabinet depth D
<b>Tekform Slimline+ drawer DW70</b>	115mm	NL + min. 3mm
<b>Tekform Slimline+ drawer DW100</b>	147mm	NL + min. 3mm
<b>Tekform Slimline+ drawer DW145</b>	198mm	NL + min. 3mm
<b>Tekform Slimline+ drawer DW182</b>	230mm	NL + min. 3mm

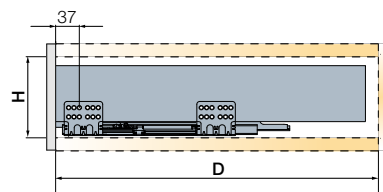

### How to fix drawer sides to the front panel?



#### EasyFix front connector

The Tekform Slimline+ drawer is available with EasyFix or screw-in front connectors

- hand insertion
- quarter turn locking system
- expandable dowel
- easy assembly and disassembly of front panel

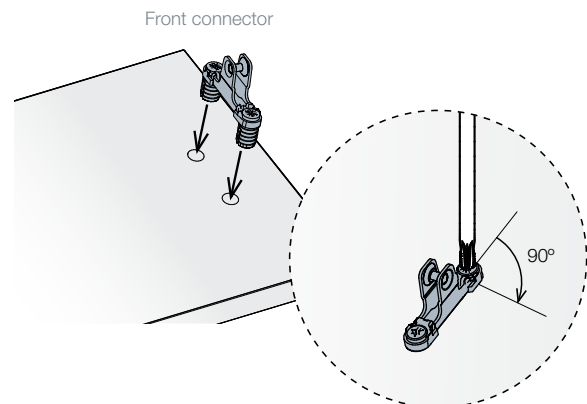

#### Screw-in front connector

- reliable connection
- fixing with Ø3.5x15mm screws (screws are not included)

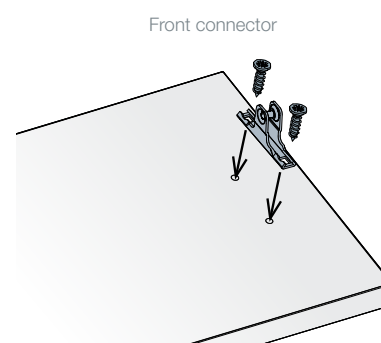

## Planning

### Bottom panel and back panel cutting dimensions

Dimensions of bottom and back panel depends on:

- cabinet width
- nominal drawer length
- drawer height

NL = Tekform Slimline+ drawer nominal length (mm)

NL	270	300	350	400	450	500	550
----	-----	-----	-----	-----	-----	-----	-----

Cabinet width

ECW: External cabinet width  
ICW: Internal cabinet width  
NL: Nominal length of drawer

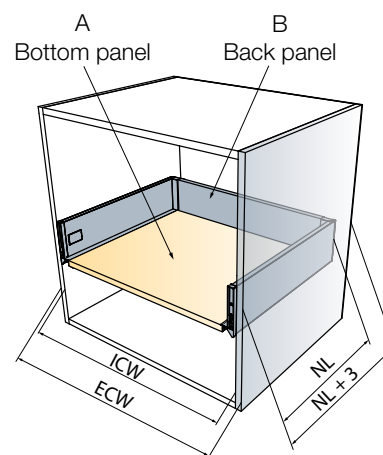

### Back panel cutting dimensions

Back panel height depends on the selected drawer height

	K
<b>DWD70</b>	68
<b>DWD100</b>	100
<b>DWD145</b>	151
<b>DWD182</b>	183

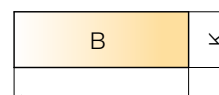

### Bottom panel cutting dimensions

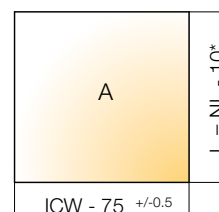

NL	270	300	350	400	450	500	550
<b>L</b>	260	290	340	390	440	490	540
<b>L<sub>st</sub></b>	250	280	330	380	430	480	530

NL = Slimline+ drawer nominal length (mm)

L = Length in case of wood back panel

L<sub>st</sub>: Length in case of steel back panel

\*For drawers with steel back panel L = NL - 20

# Tekform Slimline+ Drawer Information

## Technical Guide

### How to choose the appropriate drawer runner fixing positions?

The drawer's fixing position depends on its functional placement.

### Tekform Slimline+ drawer front positioned outside the carcass

When the drawer front is positioned outside the carcass, use the third hole on the drawer runner for fixing.

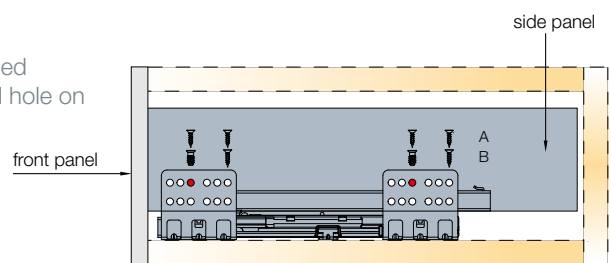

### Tekform Slimline+ drawer front positioned inside the carcass

When the drawer front is positioned inside the carcass, use the second hole on the drawer runner for fixing.

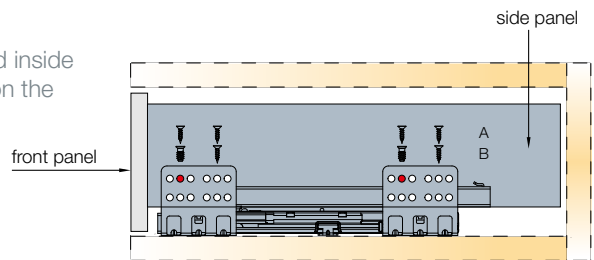

### Load capacity

Drawer load capacity is 40 kg.

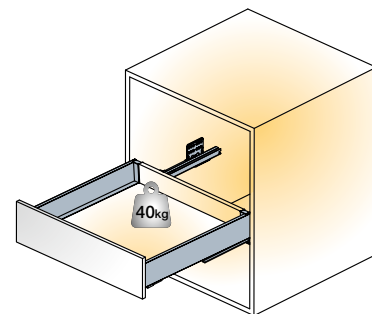

### Expanded tolerances

Tekform Slimline+ drawer provides wider tolerances in cabinet construction and assures:

- precise drawer alignment
- smooth and silent operation
- improved drawer stability in open position
- Tekform Slimline+ drawer provides a tolerance of +/- 1mm on bottom panel width size

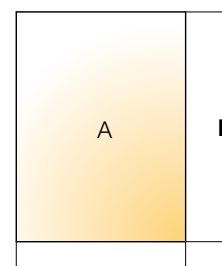

bottom panel width tolerance +/- 1mm



Adjustment needs to be done on both sides of the drawer

## Adjustments

### How to adjust the drawer front panel?

The Tekform Slimline+ drawer offers effortless three-dimensional front panel alignment, providing convenient access for side, height, and tilt adjustment positioned

at the front of the drawer side. Enhanced with colour-coded adjustment cams, for easy identification and precise alignment, guaranteeing uniform gap layouts.

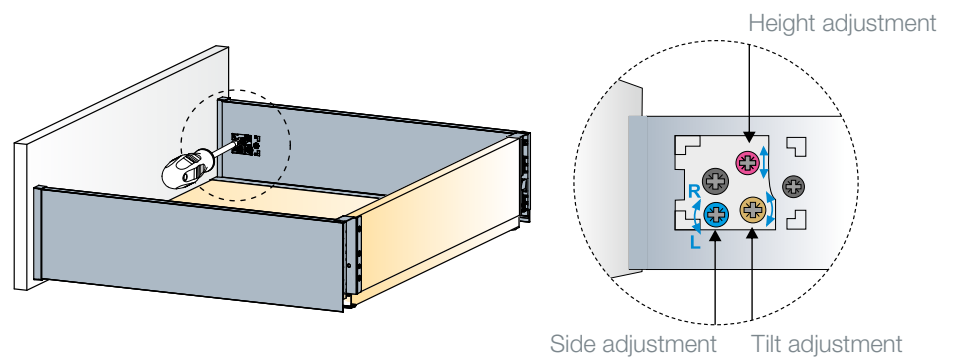

### Side adjustment

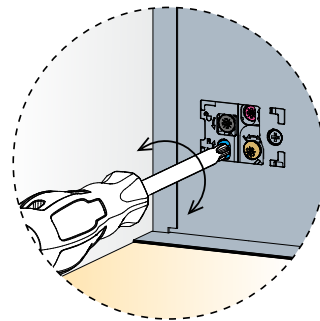
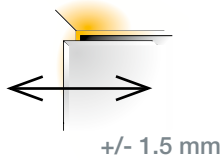

Side adjustment is done by rotating the blue coloured cam adjuster on the drawer side.

### Height adjustment

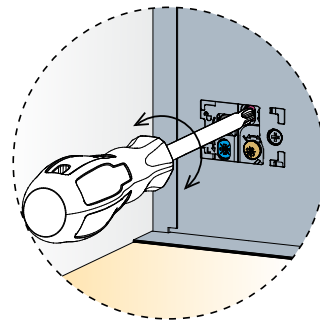
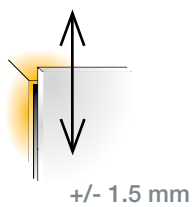

Height adjustment is done by rotating the red coloured cam adjuster on the drawer side.

### Tilt adjustment

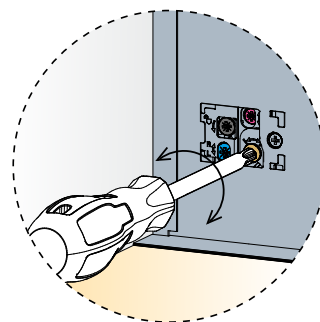
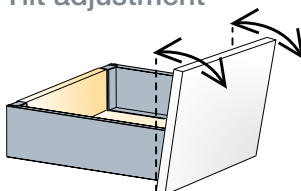

Tilt adjustment is done by rotating the yellow coloured cam adjuster on the drawer side.

# Tekform Slimline+ Drawer Information

## Key Design Choices

### ConfidentClose

Fast closing

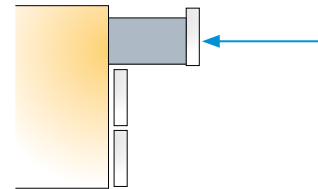

Late start of damping

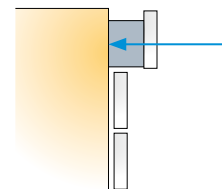

Quiet landing

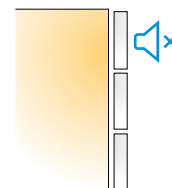

### CAF Consumer Assembly Friendliness

EasyFix front panel connector with expandable dowels provides:

- Quick, toolless insertion
- Quarter turn lock
- Repeatable assembly and disassembly

Front connector

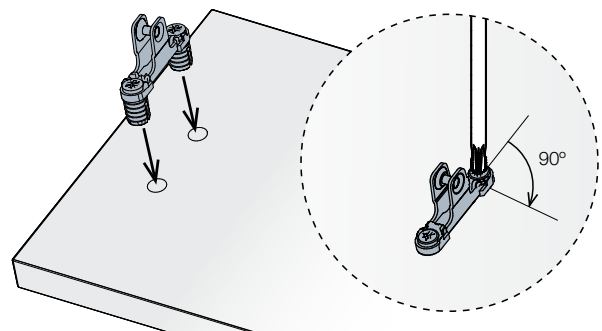

Compatible with Tacto push-opening system:

- For convenient, handle-free opening
- Same runner for both, standard and Tacto push-to-open applications
- The Tacto mechanism can be simply added as a retrofit option at any time after the drawer assembly
- For all drawers from a 300mm nominal length onwards

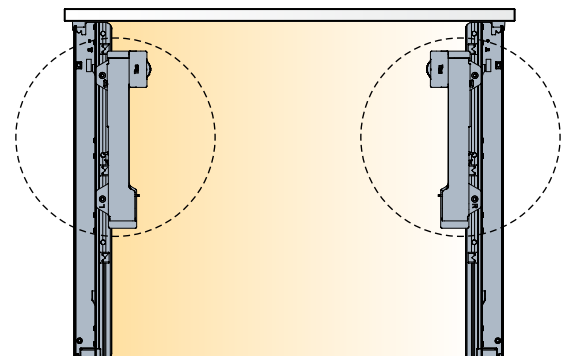



## Titus Damper inside

Designed and produced in-house

- Reliable and consistent lifelong damping
- Smooth closing
- Consistent damping performance guaranteed across high-volume production runs
- 100% automated quality check



## Damping action

Even and smooth soft closing action

- Soft and reliable closing

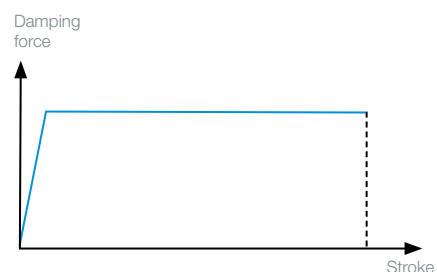

Flat damping curve shows the uniform action produced during damper closing at a defined speed.

## Response to speed

Response to speed defines the increase in damping force in relation to the closing speed of the damping object.

### Standard

The damping force increase is approximately linear to the increasing speed of closing.

### ART - Adaptive Response Technology

The damping force increase is parabolically adaptive to the increasing speed of closing. Consequently, the drawer closing is smooth, progressive, and reliable. This function allows a lower drawer opening force.

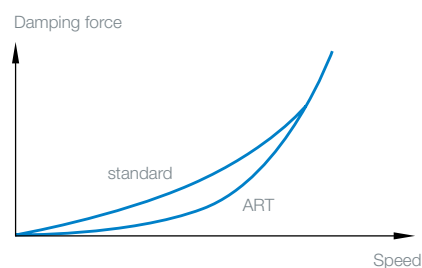

# Tekform Slimline+ Drawer DW70

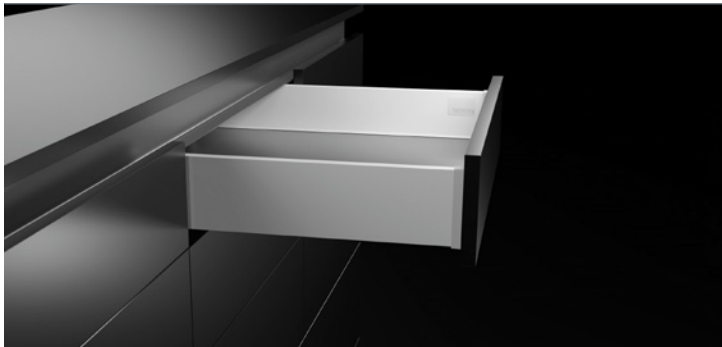
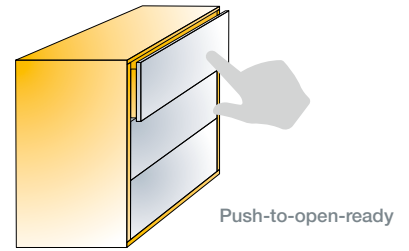

NL	with EasyFix front connector	with Screw-in front connector		
Nominal length (mm)				
	Item number for a set	Item number for a set	White	Anthracite

## Tekform Slimline+Drawer DW70

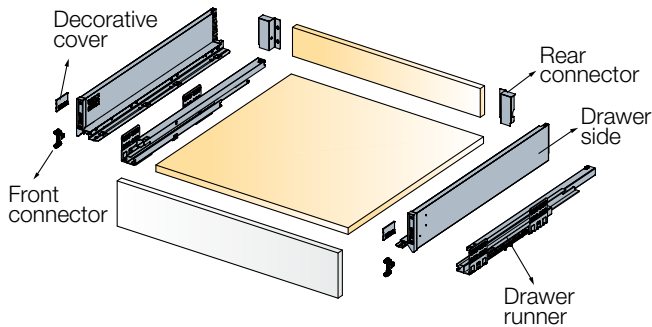

270	656-8T27 →	656-8E27 →	150	185
300	656-8T30 →	656-8E30 →	150	185
350	656-8T35 →	656-8E35 →	150	185
400	656-8T40 →	656-8E40 →	150	185
450	656-8T45 →	656-8E45 →	150	185
500	656-8T50 →	656-8E50 →	150	185
550	656-8T55 →	656-8E55 →	150	185

## Cutting dimensions details

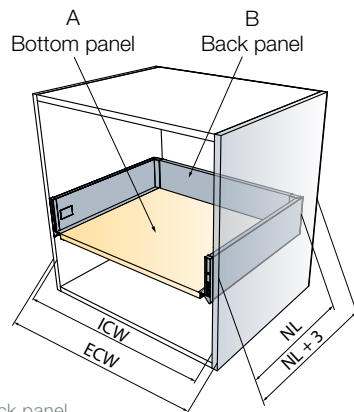

ECW: External cabinet width  
ICW: Internal cabinet width  
NL: Nominal length of drawer  
NL<sub>st</sub>: Length in case of steel back panel

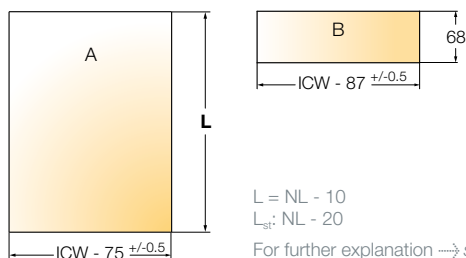

## One set consists of

Drawer sides		2 pcs
Drawer runners		2 pcs
*Front connectors		2 pcs
Rear connectors		2 pcs
Decorative covers		2 pcs
Mounting instructions		1 pc/4 sets

4 sets

Push opening



Tacto Slimline Mechanism  
→ see page 1.19

\*Front connector type depends on the item number selected.

- Drawer runner type
- Load capacity
- Minimum height space required
- Wooden back panel thickness
- Wooden bottom panel thickness

full extension  
40 kg  
115mm  
16mm  
16mm

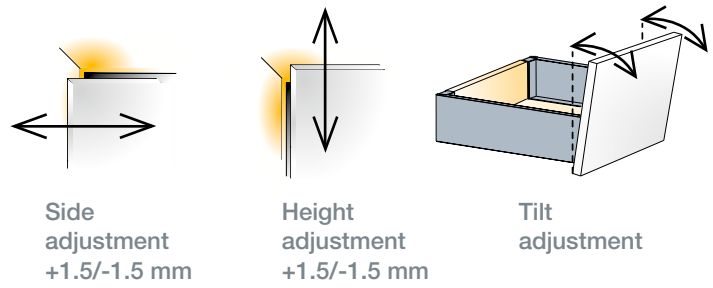

**i** Works with Tacto Push Opening Mechanism  
→ see page 1.19

For further explanation → see page 1.8

Installation dimensions and drillings

Drawer runner fixing positions

Front panel

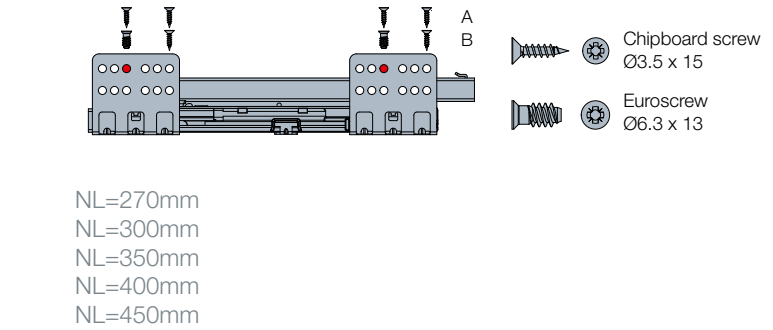
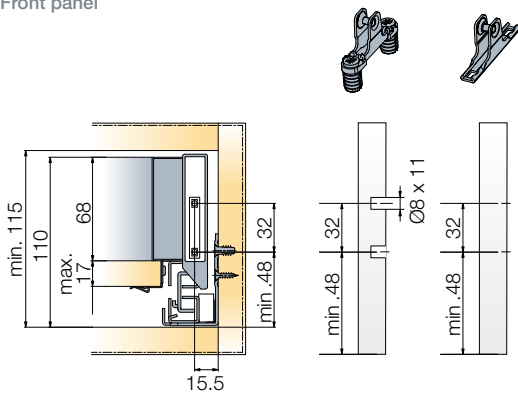

Back panel

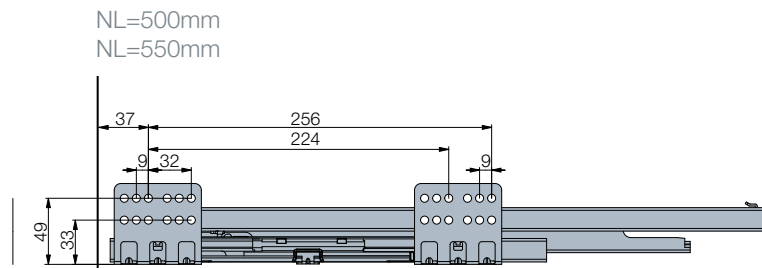
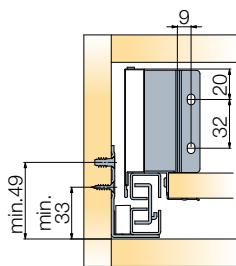

A trial mounting is always recommended.  
For further information please contact your Titus Group representative.

# Tekform Slimline+ Drawer DW100

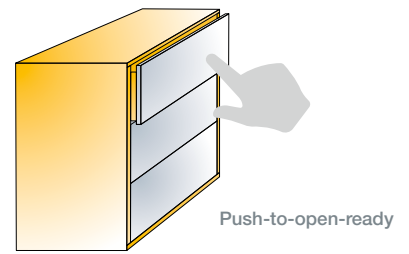

Tekform Slimline+Drawer DW100

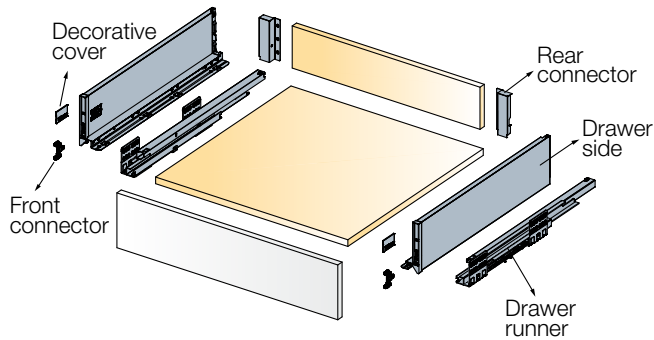

### Cutting dimensions details

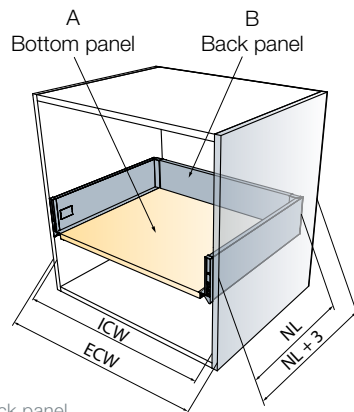

ECW: External cabinet width  
ICW: Internal cabinet width  
NL: Nominal length of drawer  
L<sub>st</sub>: Length in case of steel back panel

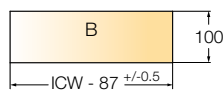
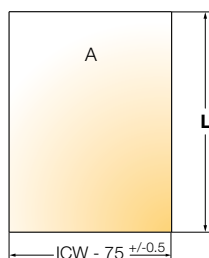

$L = NL - 10$   
 $L_{st} = NL - 20$   
For further explanation → see page 1.6



4 sets

NL	with EasyFix front connector	with Screw-in front connector		
Nominal length (mm)				
	Item number for a set	Item number for a set	White	Anthracite

270	656-8U27 →	656-8F27 →	150	185
300	656-8U30 →	656-8F30 →	150	185
350	656-8U35 →	656-8F35 →	150	185
400	656-8U40 →	656-8F40 →	150	185
450	656-8U45 →	656-8F45 →	150	185
500	656-8U50 →	656-8F50 →	150	185
550	656-8U55 →	656-8F55 →	150	185

### One set consists of

Drawer sides		2 pcs
Drawer runners		2 pcs
*Front connectors		2 pcs
Rear connectors		2 pcs
Decorative covers		2 pcs
Mounting instructions		1 pc/4 sets

Push opening



Tacto Slimline Mechanism  
→ see page 1.19

\*Front connector type depends on the item number selected.

- Drawer runner type
- Load capacity
- Minimum height per drawer required
- Wooden back panel thickness
- Wooden bottom panel thickness

full extension  
40 kg  
147mm  
16mm  
16mm

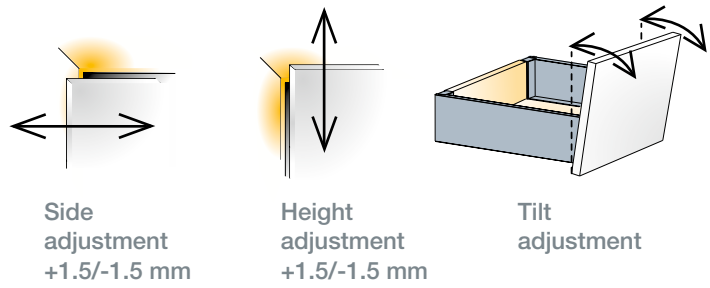

**i** Works with Tacto Push Opening Mechanism  
→ see page 1.19

For further explanation → see page 1.8

Installation dimensions and drillings

Drawer runner fixing positions

Front panel

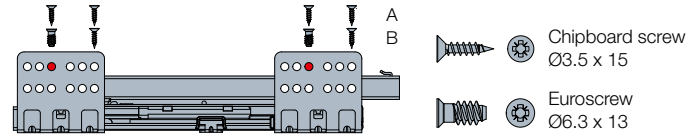
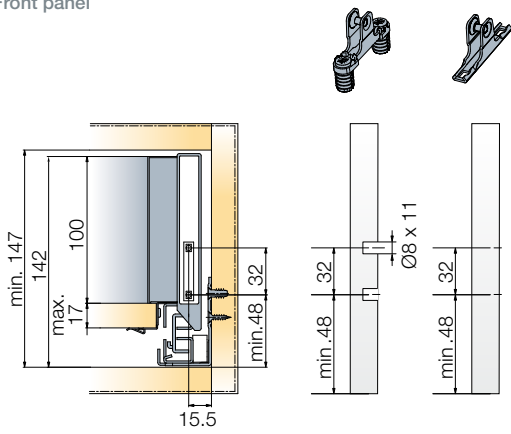

NL=270mm  
NL=300mm  
NL=350mm  
NL=400mm  
NL=450mm

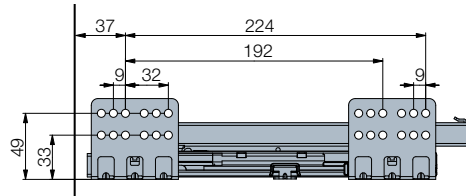

Back panel

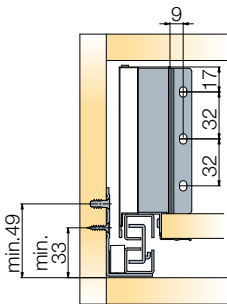

NL=500mm  
NL=550mm

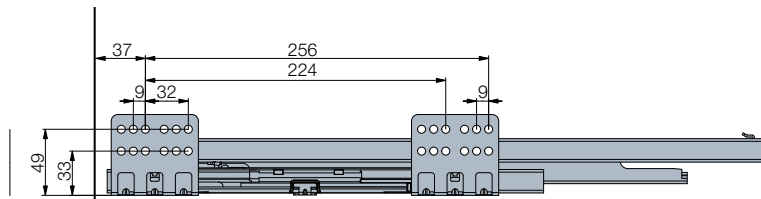

A trial mounting is always recommended.  
For further information please contact your Titus Group representative.

# Tekform Slimline+ Drawer DW145

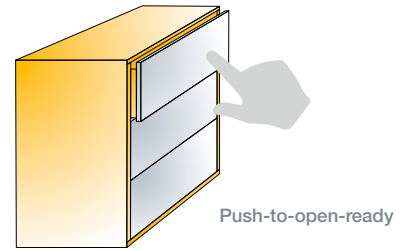

NL	with EasyFix front connector	with Screw-in front connector		
Nominal length (mm)				
	Item number for a set	Item number for a set	White	Anthracite

## Tekform Slimline+Drawer DW145

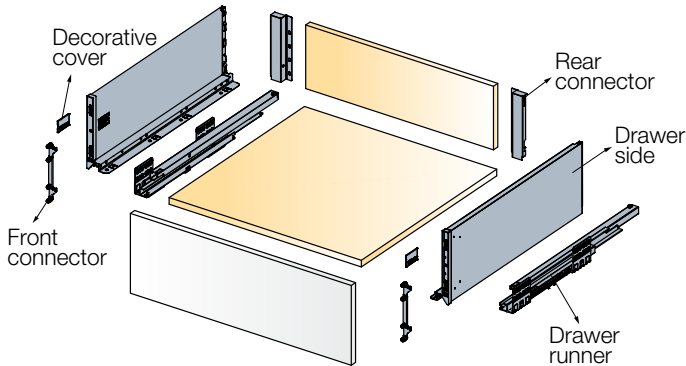

270	656-8V27 →	656-8G27 →	150	185
300	656-8V30 →	656-8G30 →	150	185
350	656-8V35 →	656-8G35 →	150	185
400	656-8V40 →	656-8G40 →	150	185
450	656-8V45 →	656-8G45 →	150	185
500	656-8V50 →	656-8G50 →	150	185
550	656-8V55 →	656-8G55 →	150	185

## Cutting dimensions details

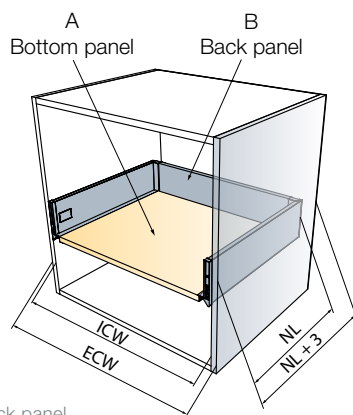

ECW: External cabinet width  
ICW: Internal cabinet width  
NL: Nominal length of drawer  
NL<sub>st</sub>: Length in case of steel back panel

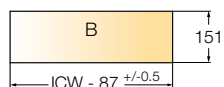
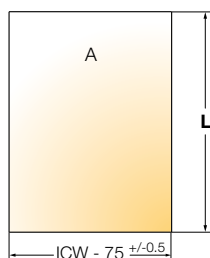

$L = NL - 10$   
 $L_{st} = NL - 20$   
For further explanation → see page 1.6

## One set consists of

Drawer sides		2 pcs
Drawer runners		2 pcs
*Front connectors		2 pcs
Rear connectors		2 pcs
Decorative covers		2 pcs
Mounting instructions		1 pc/4 sets

4 sets

Push opening



Tacto Slimline Mechanism  
→ see page 1.19

\*Front connector type depends on the item number selected.

- Drawer runner type
- Load capacity
- Minimum height per drawer required
- Wooden back panel thickness
- Wooden bottom panel thickness

full extension  
40 kg  
198mm  
16mm  
16mm

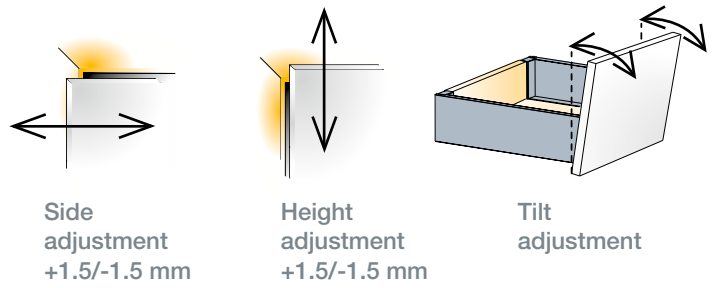

Works with  
Tacto Push Opening Mechanism  
→ see page 1.19

For further explanation → see page 1.8

Installation dimensions and drillings

Drawer runner fixing positions

Front panel

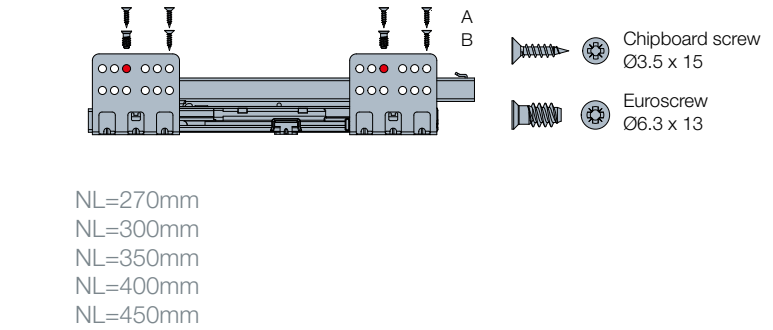
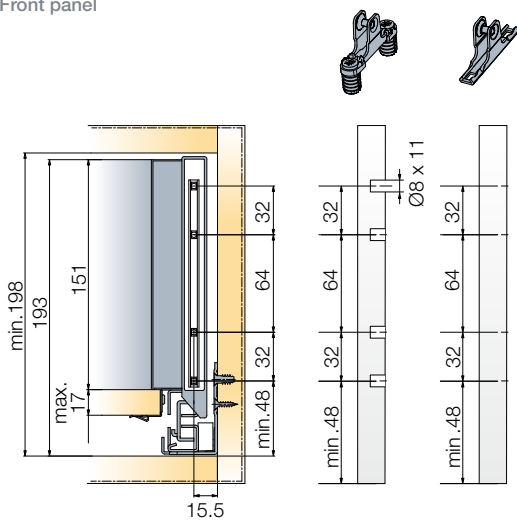

NL=500mm  
NL=550mm

Back panel

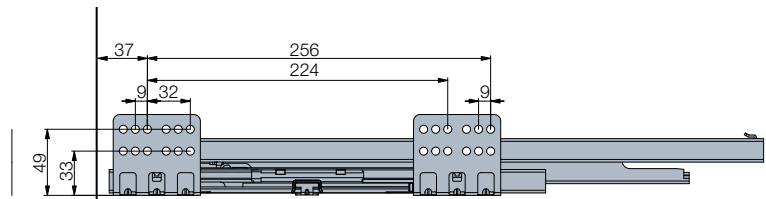
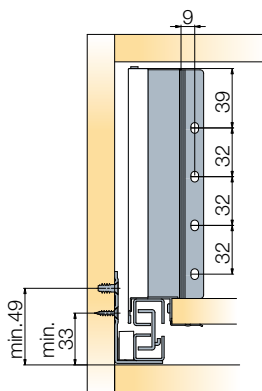

A trial mounting is always recommended.  
For further information please contact your  
Titus Group representative.

# Tekform Slimline+ Drawer DW182

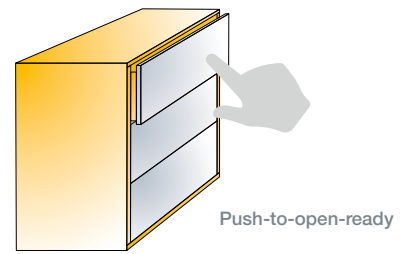

Tekform Slimline+Drawer DW182

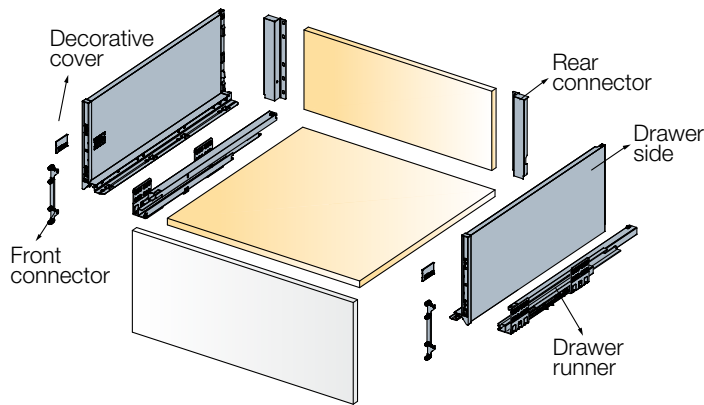

## Cutting dimensions details

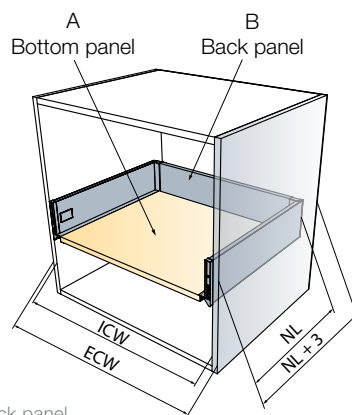

ECW: External cabinet width  
ICW: Internal cabinet width  
NL: Nominal length of drawer  
NL<sub>st</sub>: Length in case of steel back panel

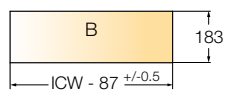
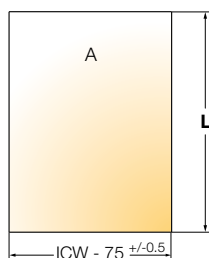

$L = NL - 10$   
 $L_{st} = NL - 20$   
For further explanation → see page 1.6



4 sets

NL	with EasyFix front connector	with Screw-in front connector		
Nominal length (mm)				
	Item number for a set	Item number for a set	White	Anthracite

270	656-8Z27 →	656-8H27 →	150	185
300	656-8Z30 →	656-8H30 →	150	185
350	656-8Z35 →	656-8H35 →	150	185
400	656-8Z40 →	656-8H40 →	150	185
450	656-8Z45 →	656-8H45 →	150	185
500	656-8Z50 →	656-8H50 →	150	185
550	656-8Z55 →	656-8H55 →	150	185

## One set consists of

Drawer sides  2 pcs

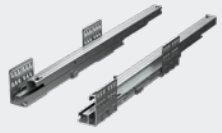
Drawer runners  2 pcs

\*Front connectors  2 pcs

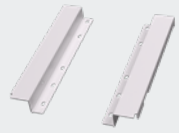
Rear connectors  2 pcs

Decorative covers  2 pcs

Mounting instructions  1 pc/4 sets

Push opening



Tacto Slimline Mechanism  
→ see page 1.19

\*Front connector type depends on the item number selected.



- Drawer runner type
- Load capacity
- Minimum height per drawer required
- Wooden back panel thickness
- Wooden bottom panel thickness

full extension  
40kg  
230mm  
16mm  
16mm

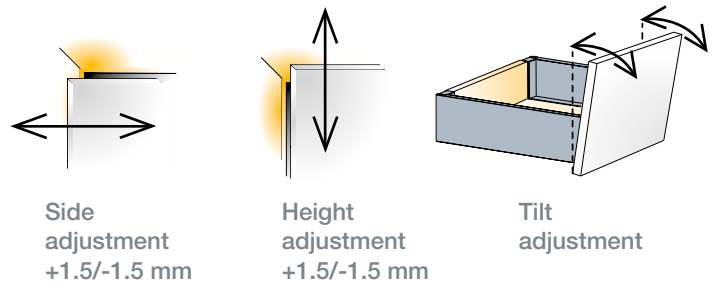

**i** Works with Tacto Push Opening Mechanism  
→ see page 1.19

For further explanation → see page 1.8

Installation dimensions and drillings

Drawer runner fixing positions

Front panel

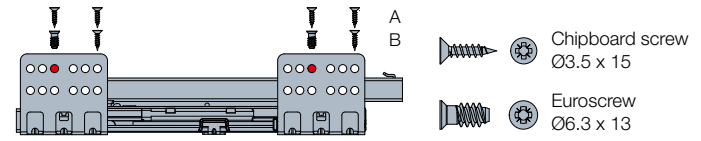
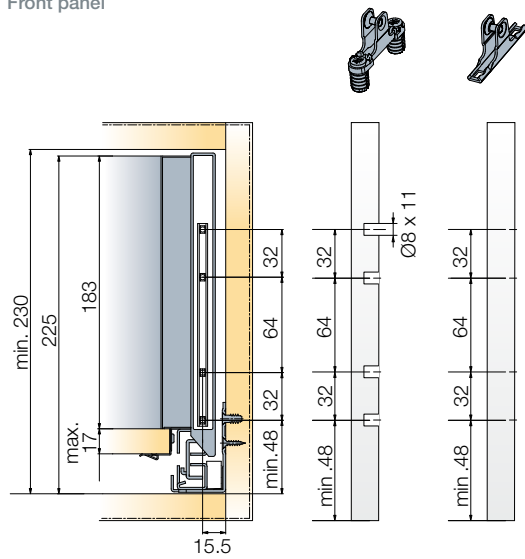

NL=270mm  
NL=300mm  
NL=350mm  
NL=400mm  
NL=450mm

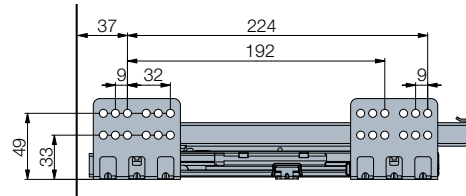

NL=500mm  
NL=550mm

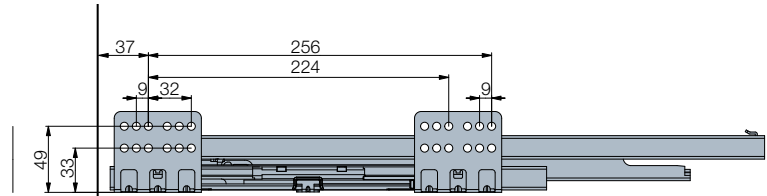

Back panel

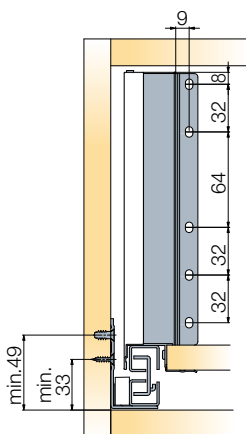

A trial mounting is always recommended.  
For further information please contact your  
Titus Group representative.

# Accessories

## Tacto Push Opening Mechanism

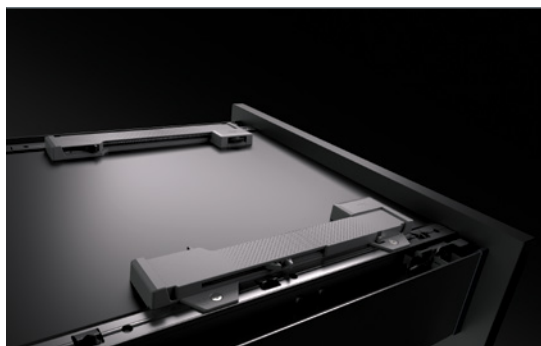
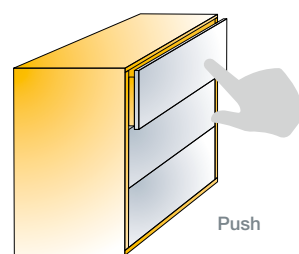

Tacto 2.0

Technical details

Item number for set

656-9220-383-K1



One set consists of:

PushOpen Mechanism



2 pcs

Tacto Activator



2 pcs

Chipboard screws



1 pc/set

Mounting instructions



1 pc/set

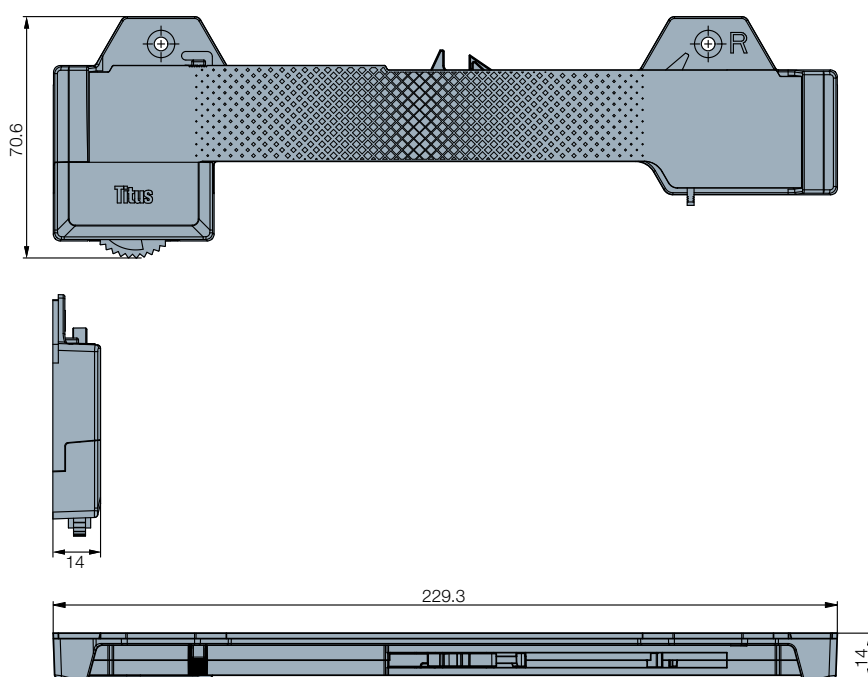

 30 sets

Made of plastic

- Intuitive mounting
- One-for-all – One item fits all Slimline+ drawers
- Easily adjustable push-to-open activation with only 1.5mm gap to operate
- Easy opening, reliable closing

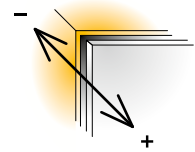

Front gap adjustment  
-1.5/+3.5mm

Mounting details

Tacto positioning

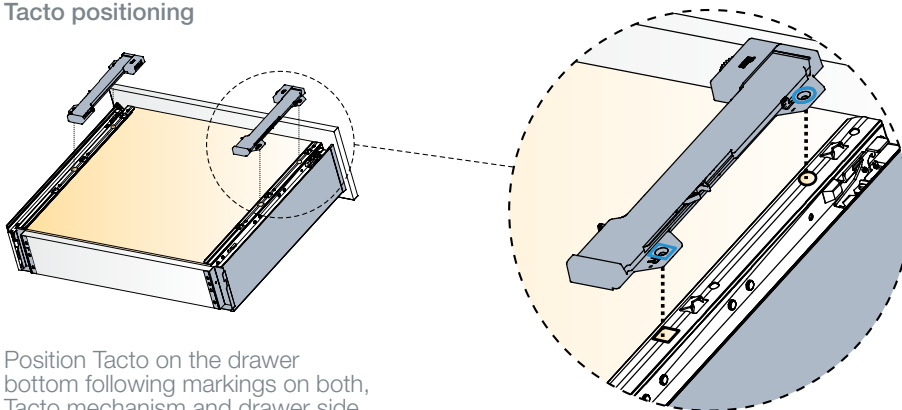

Position Tacto on the drawer bottom following markings on both, Tacto mechanism and drawer side, and screw on both sides.

Align Tacto mechanism with positioning recesses on the drawer sides

Mounting of activator

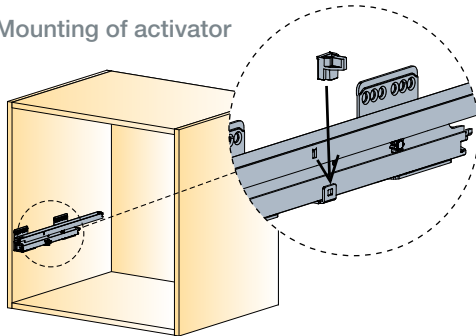

Drawer runner is Tacto ready. Mount the activator onto the bracket.

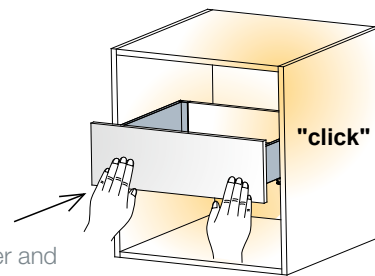

1. Insert the drawer on the runner and push till the end position.
2. Pull the drawer out again and push back in until you hear a 'click'.
3. Tacto is now engaged.

Adjustments

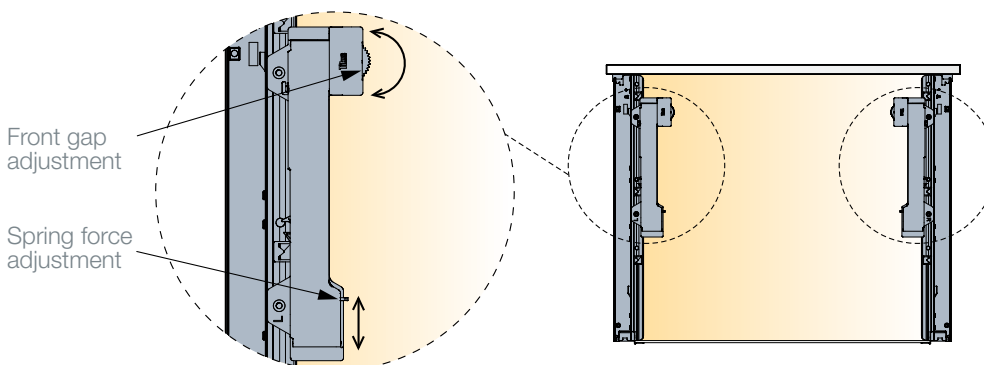

Front gap adjustment

Spring force adjustment

Front gap adjustment:  
Factory preset value 2mm  
Adjustment range: -1.5/+3.5mm





Spring force adjustment:  
The force can be increased/decreased through the adjustment switch

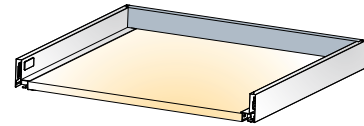

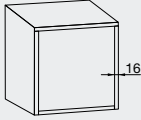
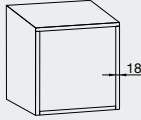

# Accessories

## Steel Back Panel

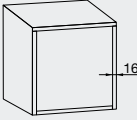
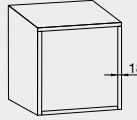

Mounting see page 1.27

	ECW	Cabinet side thickness 16mm	Cabinet side thickness 18mm		
				White	Anthracite
	External cabinet width (mm)				
<b>Steel back panel DW70</b> 	300	655-7L01	655-7L30	150	185
	400	655-7L02	655-7L40	150	185
	500	655-7L03	655-7L50	150	185
	600	655-7L04	655-7L60	150	185
	700	655-7L05	655-7L70	150	185
	800	655-7L06	655-7L80	150	185
	900	655-7L07	655-7L90	150	185
	1000	655-7L08	655-7L10	150	185
	1200	655-7L09	655-7L12	150	185
	 10 pcs      Made of steel				
<b>Steel back panel DW100</b> 	300	655-7M01	655-7M30	150	185
	400	655-7M02	655-7M40	150	185
	500	655-7M03	655-7M50	150	185
	600	655-7M04	655-7M60	150	185
	700	655-7M05	655-7M70	150	185
	800	655-7M06	655-7M80	150	185
	900	655-7M07	655-7M90	150	185
	1000	655-7M08	655-7M10	150	185
	1200	655-7M09	655-7M12	150	185
	 10 pcs      Made of steel				

	ECW	Cabinet side thickness 16mm	Cabinet side thickness 18mm		
				White	Anthracite
External cabinet width (mm)					
<b>Steel back panel DW145</b>  	300	655-7F01	655-7F30	150	185
	400	655-7F02	655-7F40	150	185
	500	655-7F03	655-7F50	150	185
	600	655-7F04	655-7F60	150	185
	700	655-7F05	655-7F70	150	185
	800	655-7F06	655-7F80	150	185
	900	655-7F07	655-7F90	150	185
	1000	655-7F08	655-7F10	150	185
	1200	655-7F09	655-7F12	150	185
	 10 pcs      Made of steel				
<b>Steel back panel DW182</b>  	300	655-7H01	655-7H30	150	185
	400	655-7H02	655-7H40	150	185
	500	655-7H03	655-7H50	150	185
	600	655-7H04	655-7H60	150	185
	700	655-7H05	655-7H70	150	185
	800	655-7H06	655-7H80	150	185
	900	655-7H07	655-7H90	150	185
	1000	655-7H08	655-7H10	150	185
	1200	655-7H09	655-7H12	150	185
	 10 pcs      Made of steel				

# Assembly Instructions



Screws are not included

## Assembly Sequence

### Wooden back panel assembly

Connect the drawer sides to the bottom panel (1) and fix it with screws (2).

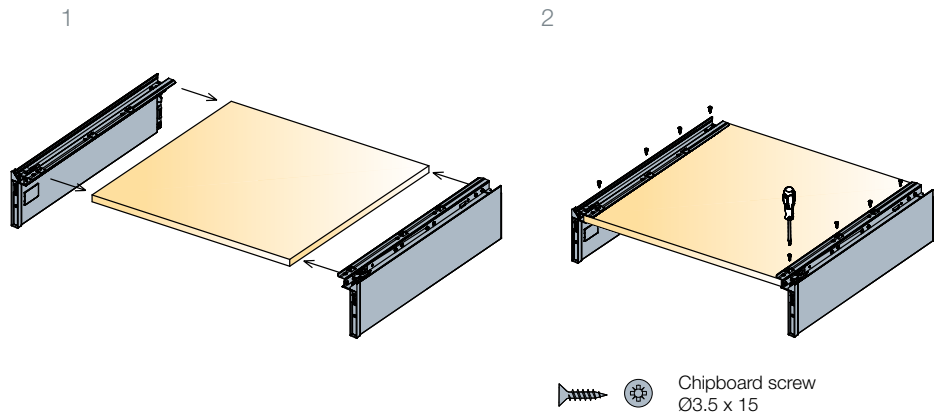

Insert the rear connectors and the back panel vertically into the recess in the drawer sides (3).  
Fix the back panel in place using screws (4).

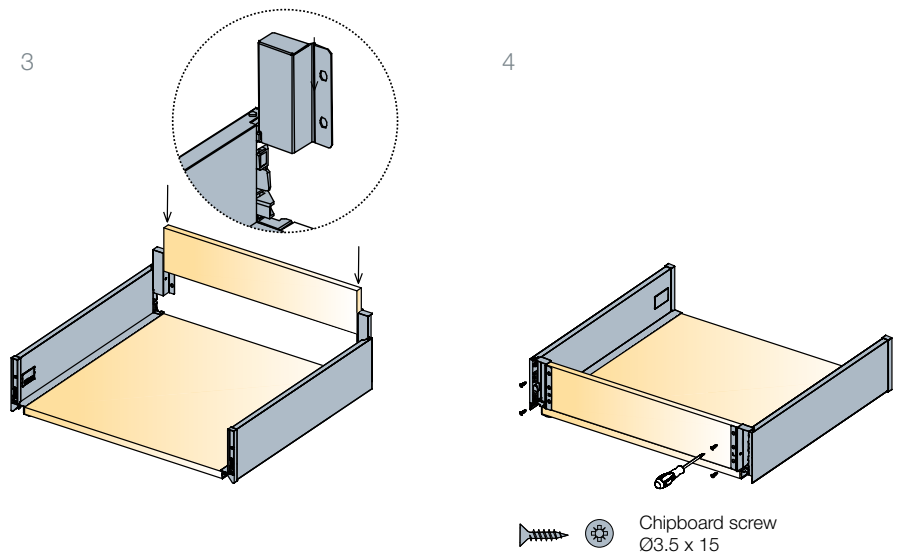



Screws are not included

## Insertion of Front Connectors

### EasyFix

Insert the front connectors into holes on the front panel

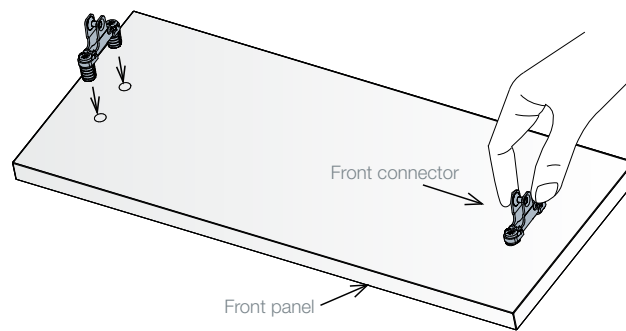

Turn the screws 90° into locked position

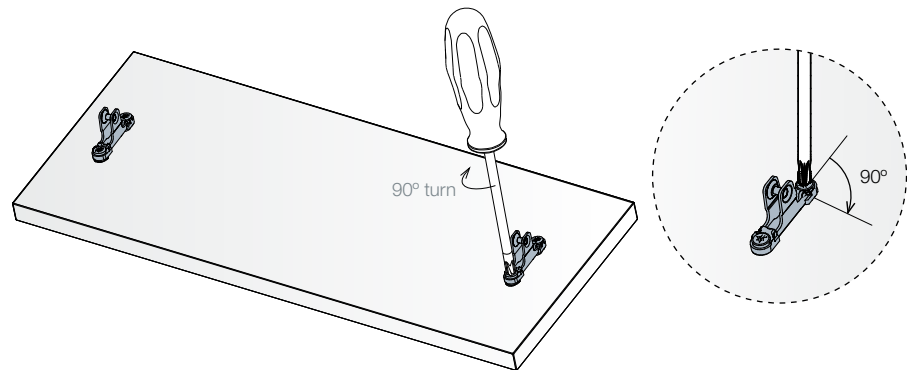

### Screw-in fixing

Use Ø3 x 15mm screws for fixing

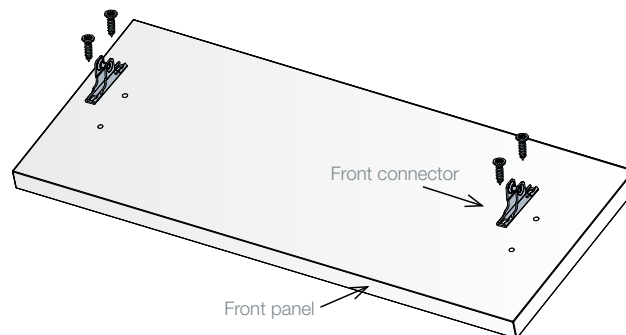

 Chipboard screw  
Ø3.5 x 15

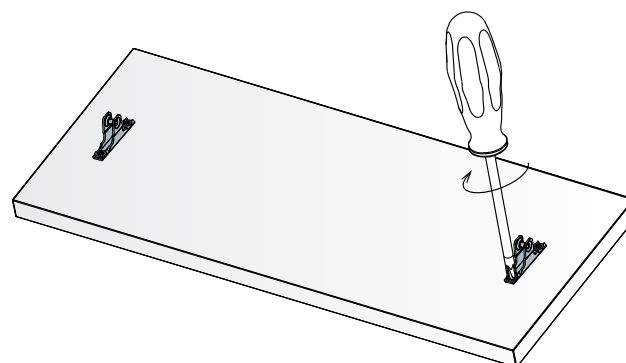

# Assembly Instructions

## Front Panel Mounting / Removal

### Mounting

Before attaching the drawer front, make sure that the clipping mechanism is unlocked (1). Attach the drawer front to the drawer sides and press to click (2).

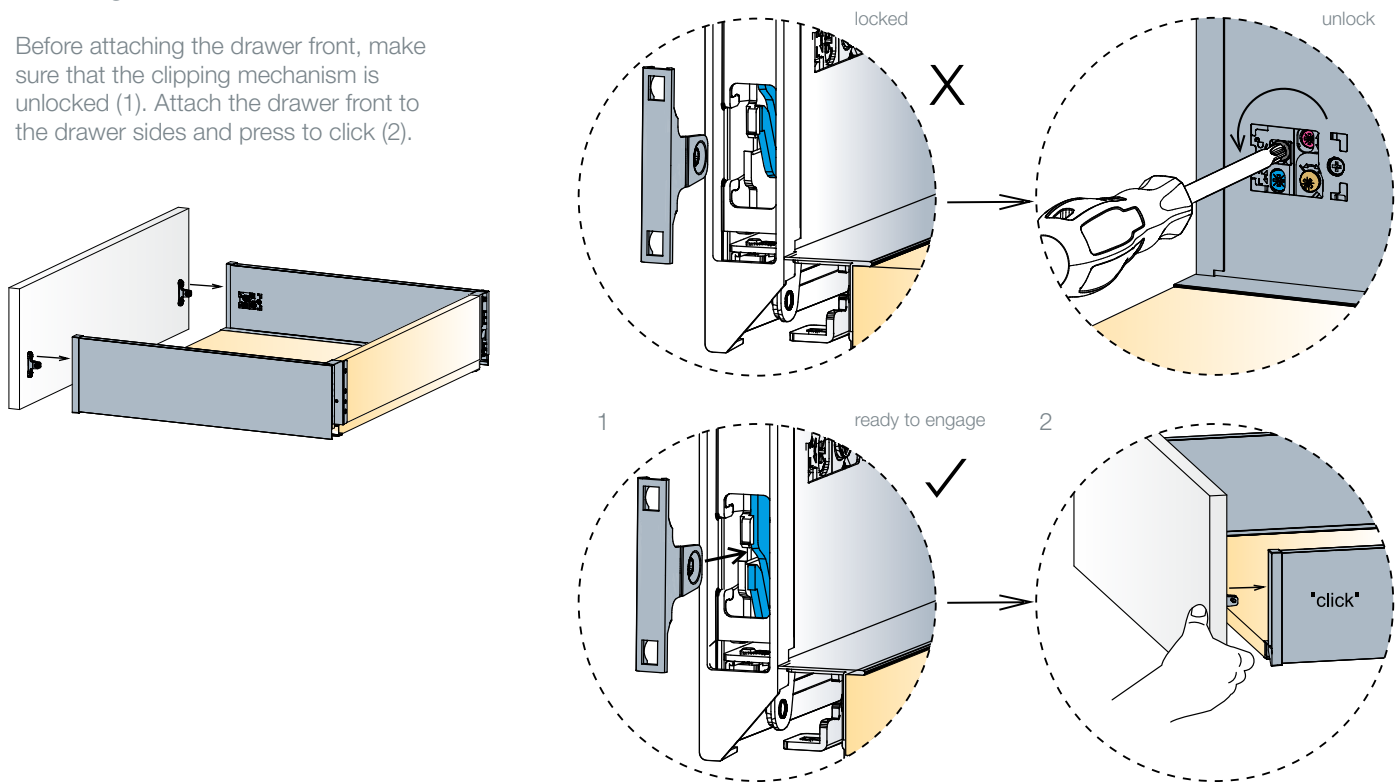

### Removal

Turn the screw towards the front panel to detach it from the drawer sides (1). Remove the front panel (2).

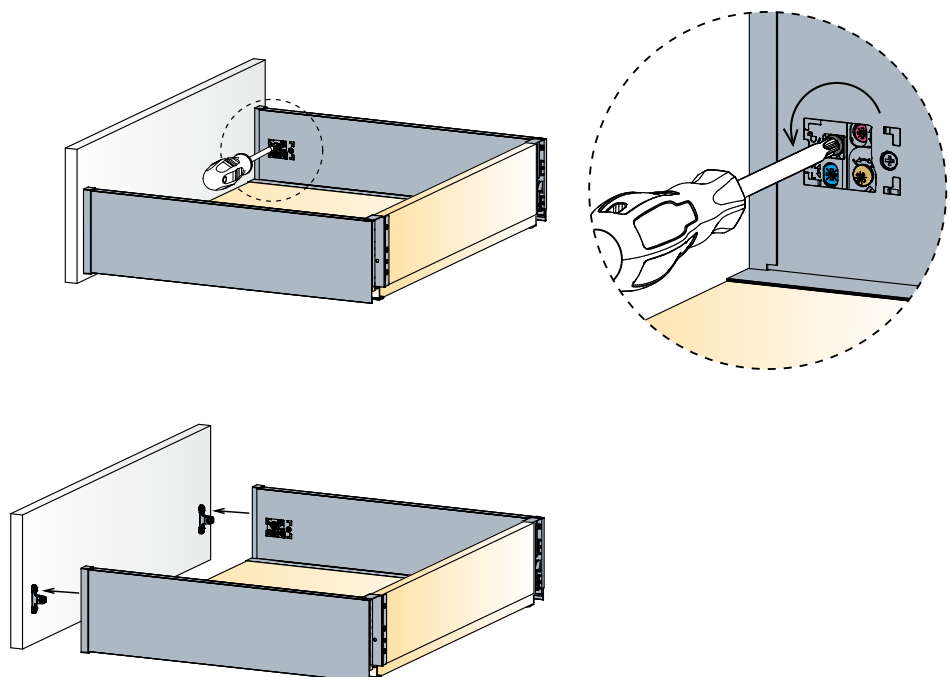



## Drawer Insertion / Removal

### Insertion

Place the drawer horizontally on the runners and push it towards the cabinet until you hear the drawer is locked

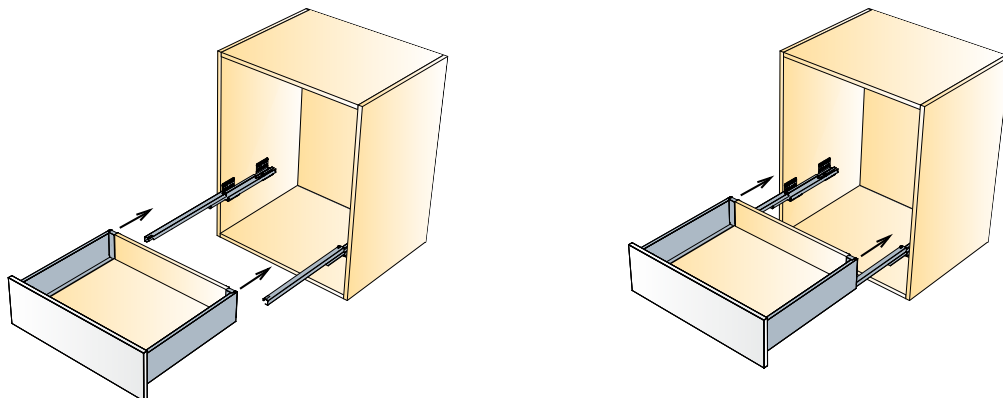

Push to fully close

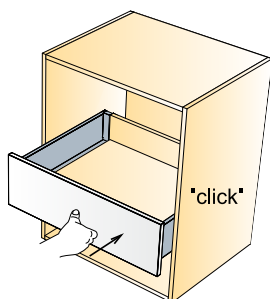

### Removal

Press upwards the button under the drawer (1). Keep pressed to pull the drawer out (2).

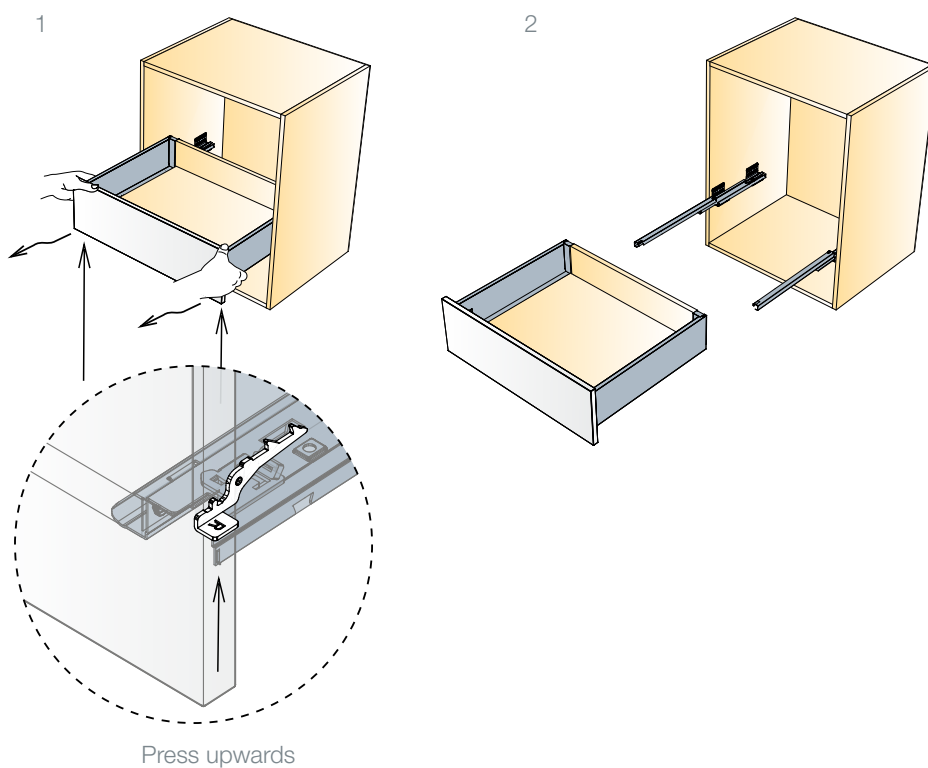

# Accessories Mounting

## Steel Back Panel



### Assembly Sequence

Insert the steel back panel vertically and push it downwards into the recess in the drawer sides (1).

Slide the bottom panel horizontally into recess at the bottom of drawer sides (2).

Fix the bottom panels with screws (3).

Fix the steel back panel with screws (4).

1

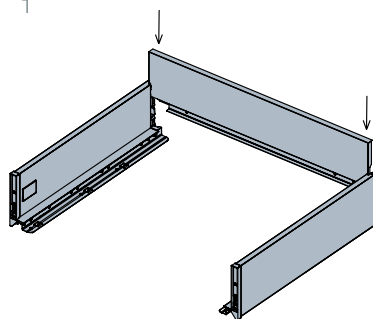

2

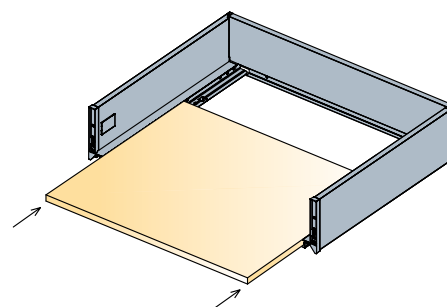

3

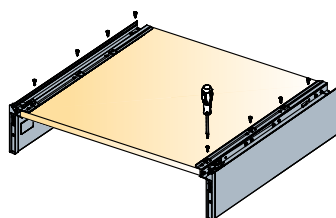

4

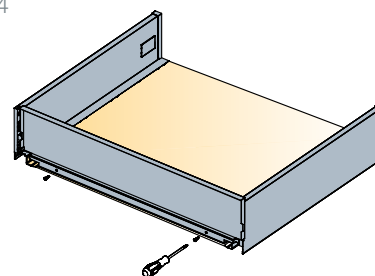

  Chipboard screw  
Ø3.5 x 15





# The Titus Group Profile

# Titus Group

Titus focuses on the design, manufacture and distribution of connectors, concealed hinges drawers and soft closing mechanisms in furniture and household appliances.

Titus Group is owned and managed from its headquarters in United Kingdom. We are able to provide products and services to every customer around the world based on manufacturing and distribution facilities in Europe, North America, China, SE Asia, Australia and New Zealand.

**Quickfit technology makes Titus the World leader in connectors for RTA furniture**

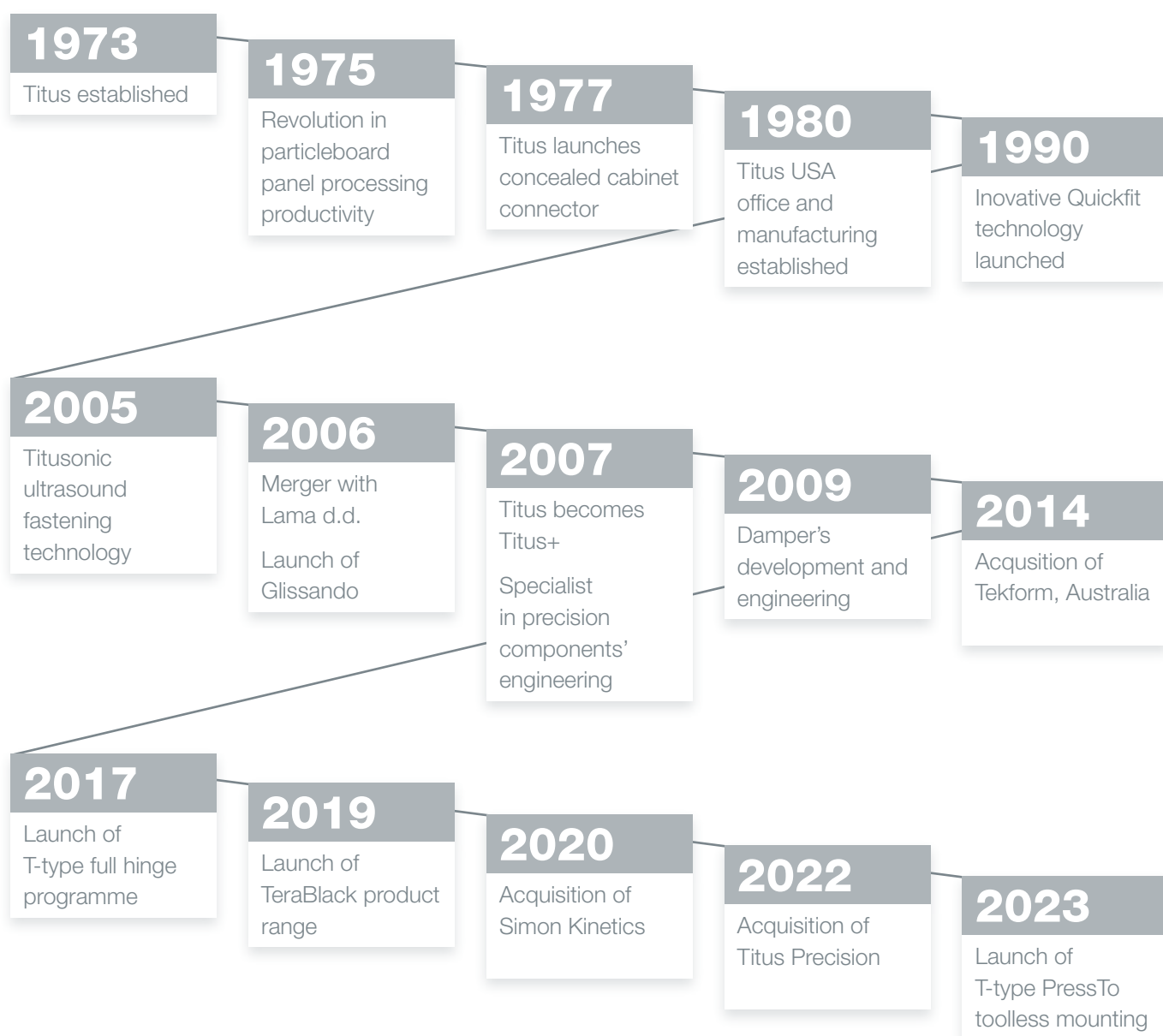

## Vision

To be the world's best in engineering for precision components

## Mission

To provide manufacturers with component solutions that improve their competitiveness

## Titus Business Principles

- Gain total knowledge of our customers and their markets
- Focus on identifying and creating high volume component niches
- Meet our customers' expectations with global consistency
- Build long term associations with customers, suppliers, colleagues and shareholders
- Invest in the abilities of individuals at every level
- Continuously enhance input efficiency and sustainability
- Provide equal opportunities to all

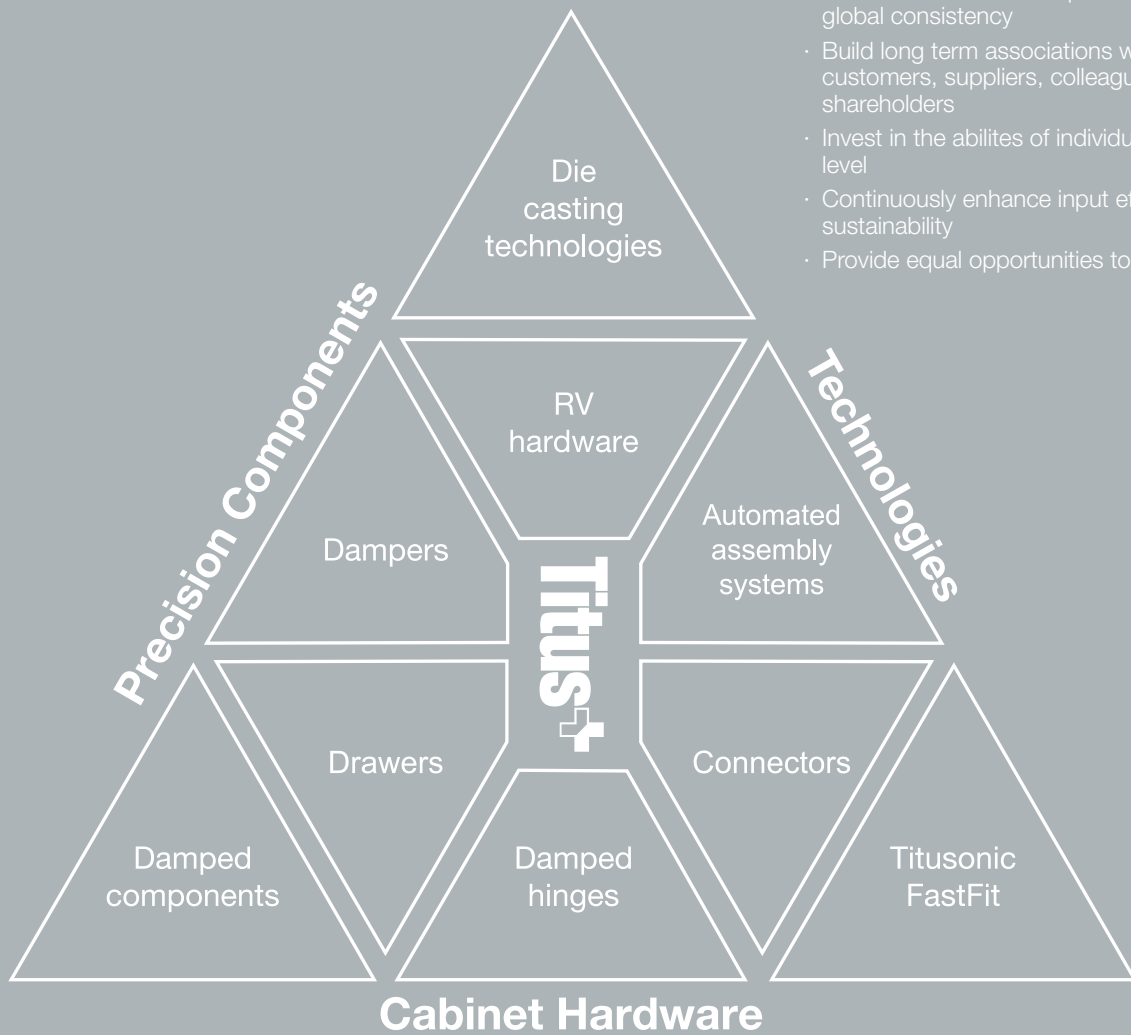

## Cabinet Hardware

- Cabinet connectors
- Concealed hinges
- Damping mechanisms
- Kitchen drawers and accessories
- RV hardware

## Damping and Kinetics

Hydraulic dampers and Slidix mechanisms for custom applications in home equipment

## Titus Technologies

- Automated assembly systems
- Die casting technologies
- Titusonic - Ultrasound fastening
- FastFit insertion technology

# 'Totally Integrated Engineering'

## Product Design

Design and engineering of unique components  
 Consistent and repeatable product quality

## Manufacturing Technologies

To improve productivity and product quality

## Manufacturing Operations

A wide array of technologies and services required for high volume production of precision components available in-house

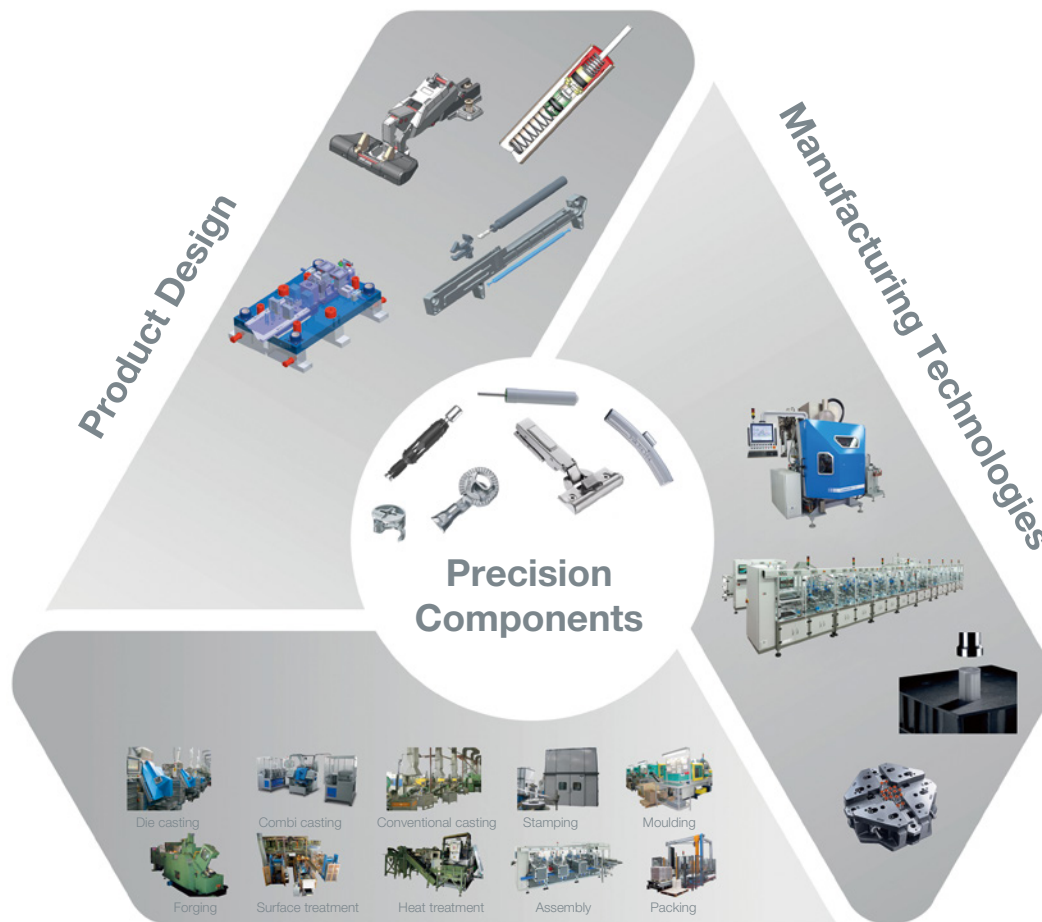

## Manufacturing Operations

## Fittings for purpose

Unique product advantages for better value for money and lower 'total installed cost'

## Innovations that improve

With less parts, less different parts, less preparation actions, faster assembly

## Fast time-to-market



# Quality

## Continuous Improvement

The Titus Group Mission, to improve the competitiveness of our customers, encourages us to continuously improve our products, services, processes and competencies of our employees.

## Quality

We believe that the Titus Mission is achieved most effectively through the management of our design, manufacturing and service activities in conformance with the ISO 9001 standard for quality management. Quality has a broad meaning for us: it is our guide to the selection of materials, work, processes, internal relations and cooperation with partners.

## Products

Our integrated quality system produces technically optimized products of high quality. They are assessed regularly in our own test labs as well as by internationally renowned institutions, such as LGA from Germany, CTBA from France, FIRA from United Kingdom, CATAS from Italy, AIDIMA from Spain, and others.

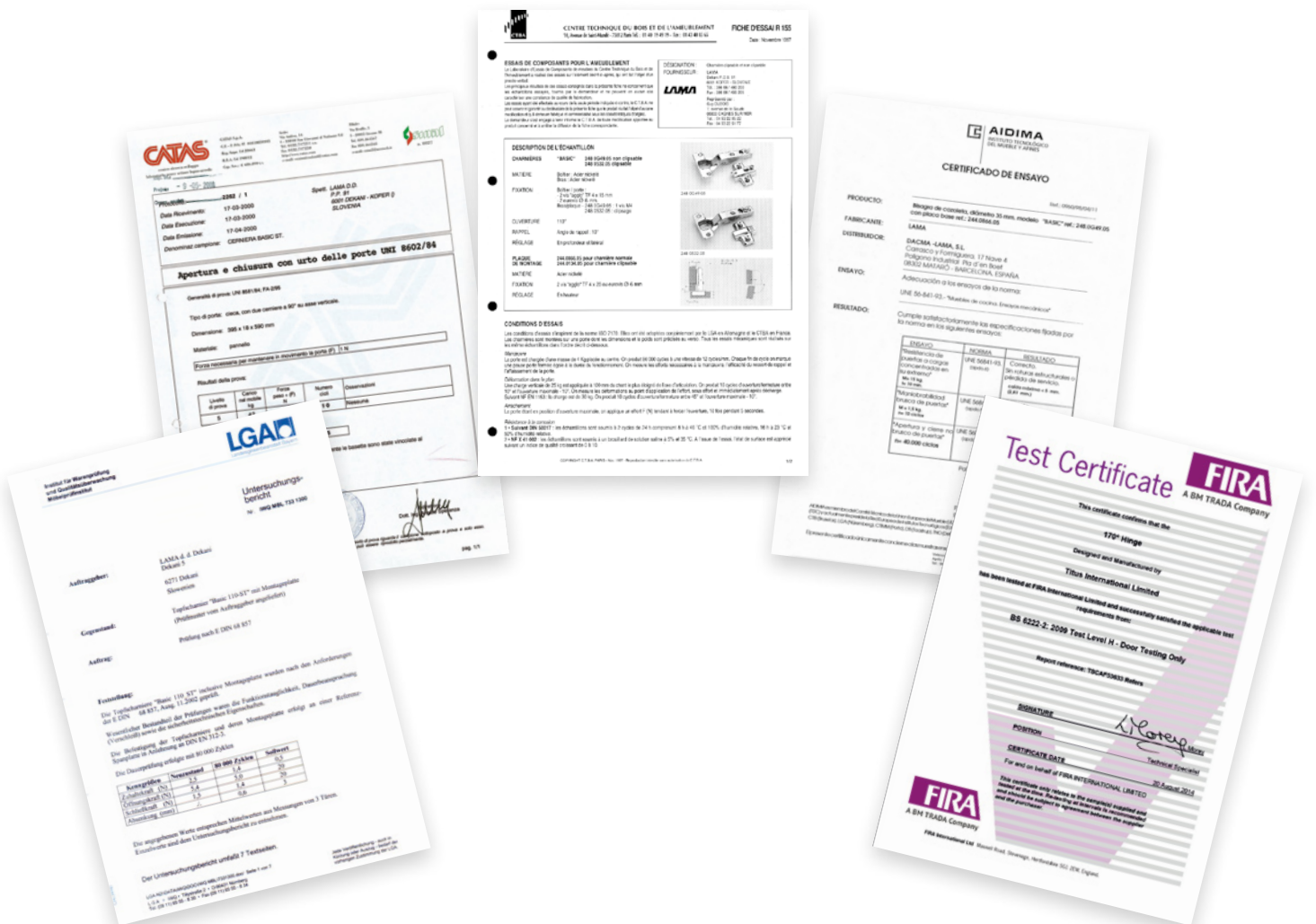

# Worldwide Design, Manufacturing and Distribution Capabilities

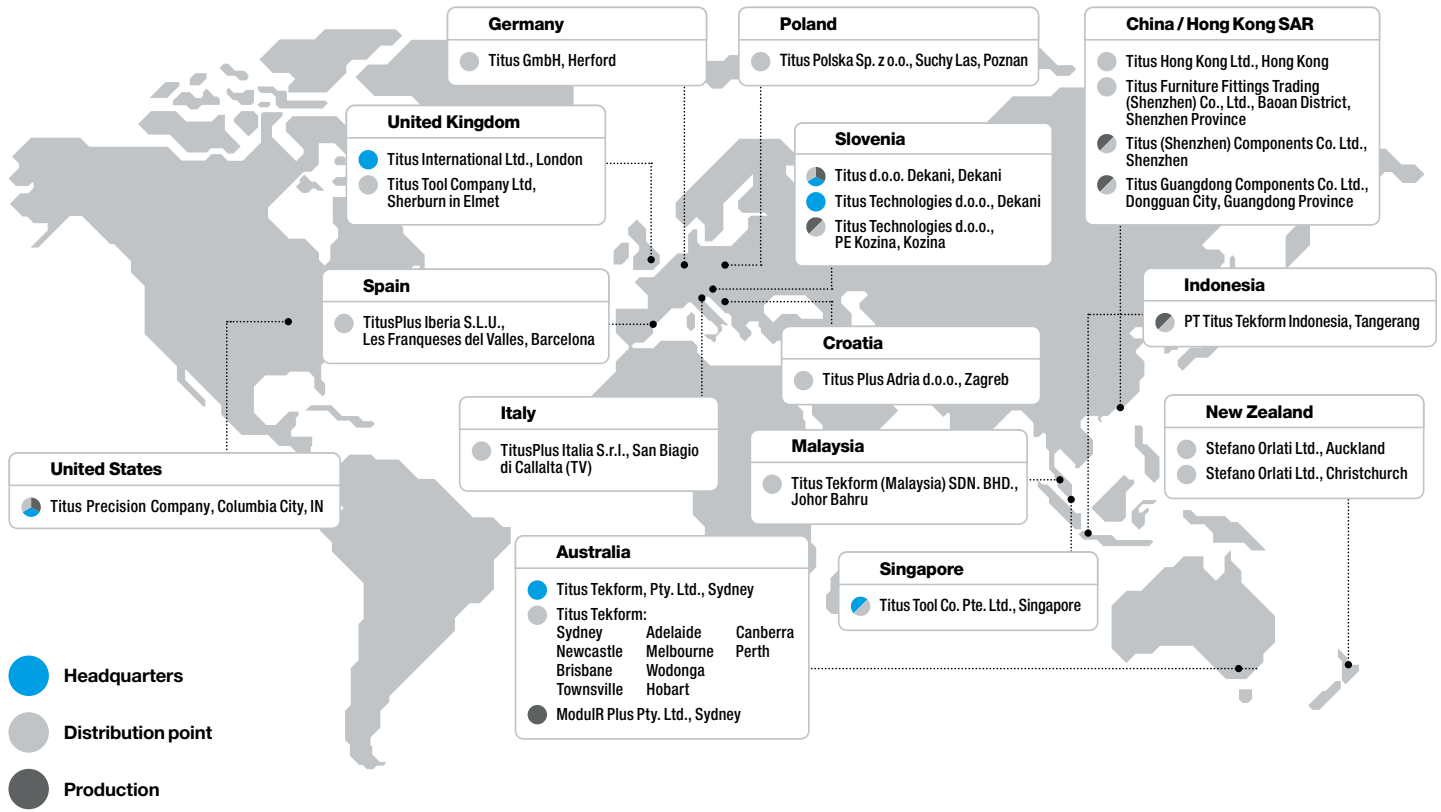

## Europe

**Titus d.o.o. Dekani**  
 Dekani 5  
 SI-6271 Dekani  
 Slovenia  
 +386 5 6690 101  
 +386 5 6690 205 Fax  
 info@titusplus.com

**Titus Technologies d.o.o.**  
 Dekani 5  
 SI-6271 Dekani  
 Slovenia  
 +386 5 6690 422  
 technologies@titusplus.com

**Titus Technologies d.o.o., PE Kozina**  
 OIC Hrpelje 36  
 SI-6240 Kozina  
 Slovenia  
 +386 5 6690 422  
 technologies@titusplus.com

**Titus Plus Adria d.o.o.**  
 Ulica Kreše Golika 3  
 HR-10090 Zagreb  
 Croatia  
 +385 1 3323 033  
 +385 1 3323 233 Fax  
 croatia@titusplus.com

**Titus Polska Sp. z o.o.**  
 Ul. Stefańskiego 17 A  
 PL-62-002 Suchy Las/Poznań  
 Poland  
 +48 61 811 5402 Phone/Fax  
 +48 61 811 5684 Phone/Fax  
 +48 61 821 9362  
 poland@titusplus.com

**TitusPlus Italia S.r.l.**  
 Via Aquileia 9  
 Frazione Olmi  
 IT-31048 San Biagio di Callalta (TV)  
 Italy  
 +39 04 221 650 120  
 +39 04 221 650 136 Fax  
 italia@titusplus.com

**TitusPlus Iberia SLU**  
 C/ Luxemburg 16  
 ES-08520 Les Franqueses del Valles  
 Spain  
 +34 938 715 404  
 +34 938 605 498 Fax  
 iberia@titusplus.com

**Titus GmbH**  
 Lübberlindenweg 12  
 DE-32049 Herford  
 Germany  
 + 49 5221 1024880  
 germany@titusplus.com

**Titus Tool Company Ltd.**  
 10 Blackburn Industrial Estate  
 Enterprise Way  
 Sherburn in Elmet  
 LS256NA  
 United Kingdom  
 + 44 1977 682582  
 + 44 1977 680481 Fax  
 uk@titusplus.com

## America

**Titus Precision Company**  
 900 W Connexion Way  
 Columbia City, IN 46725  
 United States  
 +1 260-244-6114  
 +1 260-248-5287  
 usa@titusplus.com

## Australia and New Zealand

**Titus Tekform Pty Ltd**  
 83 Jemma Road  
 Prestons NSW 2170  
 Australia  
 +61 2 9286 0007  
 +61 2 9826 0074  
 info@titustekform.com.au  
 www.titustekform.com.au

**Stefano Orlati Ltd**  
 34 Waipareira Avenue  
 Henderson  
 Auckland  
 New Zealand  
 +64 9 837 0886  
 +64 9 837 8003 Fax  
 stefano-oralati@titusplus.com  
 www.stefano-oralati.co.nz

## Asia

**Titus Tool Co. Pte. Ltd.**  
 5004 Ang Mo Kio Ave 5  
 Techplace II #04-01  
 Singapore 569872  
 Singapore  
 +65 6383 3922  
 +65 6383 3178 Fax  
 singapore@titusplus.com

**Titus Guangdong Components Co. Ltd.**  
 Room 101, Building No. 1  
 No. 358 Daxing Road  
 Yangwu Village, Dalingshan Town  
 Dongguan City  
 Guangdong Province  
 China  
 +86 769 85659801 803  
 china@titusplus.com

**Titus Shenzhen Components Co. Ltd.**  
 1st Floor Building No. 2  
 Heng Changrong High-tech  
 Industrial Park  
 ShangNan South Road  
 Shangjin Street  
 Bao'an District  
 Shenzhen City  
 Guangdong Province  
 China  
 +86 755 8348 0916  
 +86 8359 2676  
 china@titusplus.com

**Titus Tekform Indonesia, PT**  
 Taman Teknoblok L2 No. 7  
 Bumi Serpong Damai Sektor XI  
 15314 Tangerang  
 Indonesia  
 +62 21 70753578  
 +62 21 75873574 Fax  
 indonesia@titusplus.com

## Headquarters

Titus International Ltd  
 28 Fitzroy Square  
 W1T 6DD London  
 United Kingdom  
 +44 20 8004 8083  
 info@titusplus.com  
 www.titusplus.com



*Your authorized dealer*