

System 5 Cams and Dowels

System Features

The most advanced cam and dowel range

Titus System 5 is a comprehensive range of cam and dowel connecting fittings with 'Klix' and Quickfit features for all cabinet applications: panel-to-panel, panel-to-hollow profile, back-to-back

Dowels

- **Quickfit TL5, 'Full metal jacket'**
a high performance Quickfit dowel for use in multiple wooden materials
- **Quickfit TL2, TL4, TL5 dowels**
a unique solution for factory pre-insertion, high level of drilling tolerances

- **Quickfit dowels**
quick hand insertion, easy assembly
- **Diecast dowels (zinc)**
precise manufacturing, optimal shape and design
- **Turned dowels (steel)**
'traditional' design, smooth surface, best strength performance
- **Combi dowels (zinc and steel)**
high precision of zinc, strength of steel, 100% dimensional accuracy and optimal performance

Titus 'Klix'TM

Titus 'Klix' locking system ensures the engagement of the interlocking teeth on cam and dowel providing:

- vibration-proof joint
- rigid construction that will not loosen in service or transit

Dowel insertion time comparison

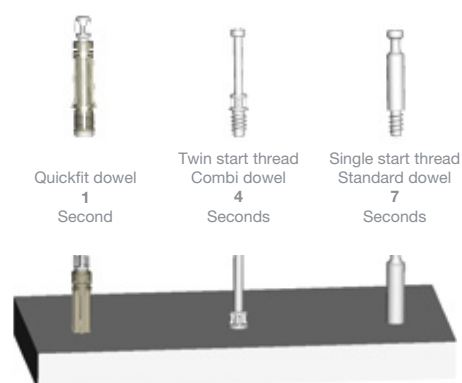

2 o'clock lock Smooth closing

Linear cam profile assures smooth, firm tightening action and greater pull-up. The cam always locks at 2 o'clock lock (230°), enabling greater consumer confidence in use while improving furniture quality.

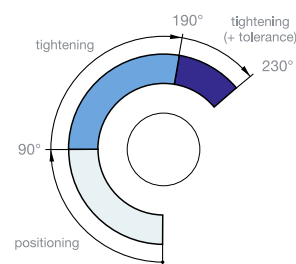

Drilling tolerances

Optimal performance and perfect joint even with inaccurate drillings.

Zinc/Combi dowel

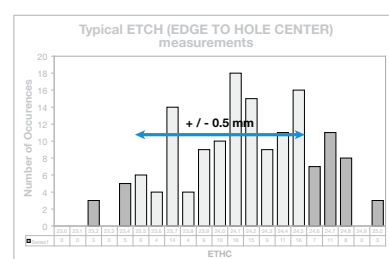
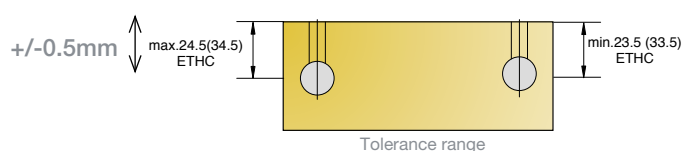

Quickfit TL5 dowel, Quickfit TL2 dowel

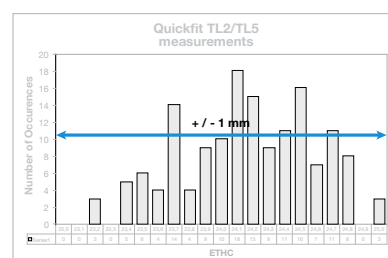
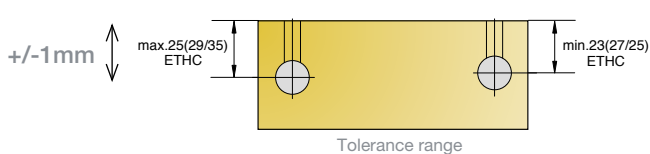

Quickfit TL4 dowel

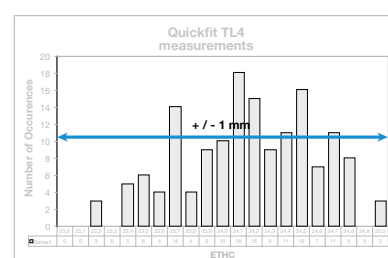
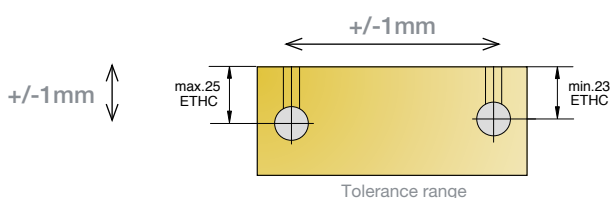

ETHC=Edge To Hole Center

Dowels for factory insertion

Quickfit TL5, Quickfit TL4 and Quickfit TL2 are the only available dowels allowing factory preinsertion

- Easier packing
- Less damages in handling
- Perfect for the RTA market

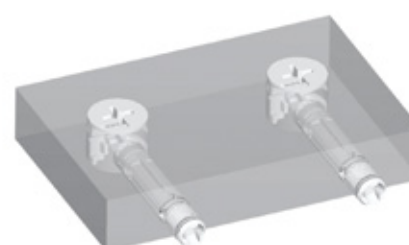

System 5 Cams and Dowels

Cam5000

Highly resistant joint for strong cabinet construction

Reinforced cam evenly engages the hole and prevents cam tilting and cam bursting.

Increased joint resistance enables effective performance in wider tolerance range.



Linear cam profile

Linear cam profile ensures:

- Smooth tightening action
- Greater dowel pull-up



Cam retaining pips

Cam retaining pips ensures:

- The cam is held in position prior to assembly
- Secure cam positioning during transport and handling
- Accurate factory insertion



2 o'clock lock

Smooth and noticeable locking at the 2 o'clock position guarantees:

- always-right tightening for home assembly
- strong and rigid cabinet construction

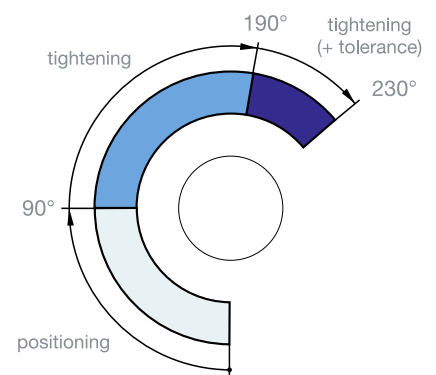

Optimised cam profile

Optimised cam profile ensures smooth and tight joint with no gap between panels.

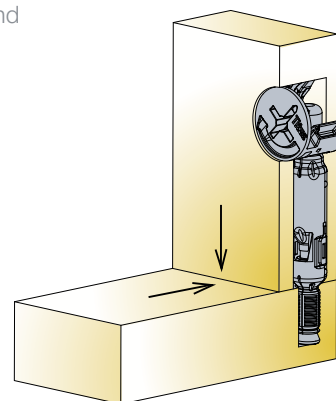

Optimal performance with all Titus dowels

Quickfit TL, Quickfit, Combi, end, double ended, angled and other screw-in dowels



System 5 Cams and Dowels

Quickfit Connectors

It is the fastest assembly system on the market. The Quickfit™ dowel may be inserted by hand, using only finger pressure. This eliminates the labour intensive process of screw-in assembly and the potential panel damage.

The Quickfit™ range of dowels has been extended to provide a complete family of fittings available in diameters of 5mm, 8mm, 10mm and lengths of 24mm and 34mm. These dowels are compatible with the range of Titus Ø15mm cams.

Assembly

1. Press the cam into face board

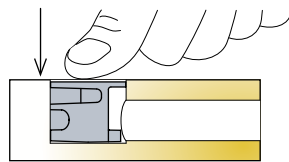

2. Insert the dowel into side panel

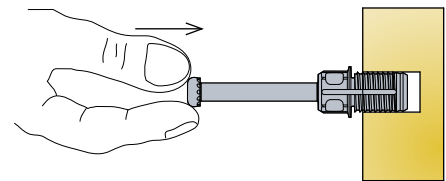

3. Assemble the panels

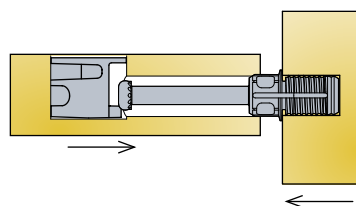

4. Tighten the cam to lock dowel

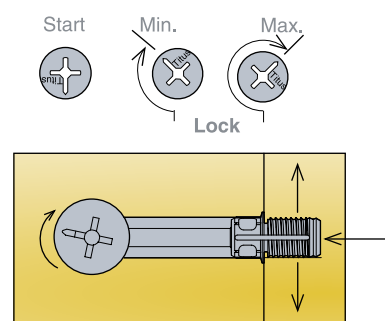

5. Assembled panels

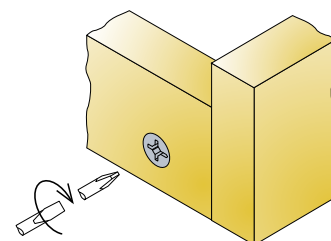

Quickfit TL Connectors

Quickfit-TL™ dowel offers furniture manufacturers a fast assembly system providing high drilling tolerances. It has a built-in self-adjustment feature, which enables common drilling inaccuracies to be overcome.

For the self-assembly furniture consumer, Titus Quickfit-TL™ is the most consumer friendly fitting on the market. Apart from the benefit of fully tightened joints and easy locking into the same position, Quickfit-TL™ provides an exceptionally smooth action when tightened, requiring very little effort.

Drilling tolerances

Marginal inconsistencies of drilling and the problems associated with the natural movement of wood panels, no longer present problems.

Quickfit-TL™ provides a tolerance of ± 1 mm on drilling operation while ensuring that the final result is a perfectly precise and aligned joint. No other assembly fittings system can offer such tolerances and still maintain a perfect joint.

Assembly

1. Press the cam into face board



2a. Either push dowel into edge hole or...

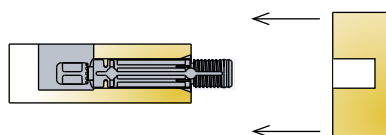

2b. Insert the dowel into side panel

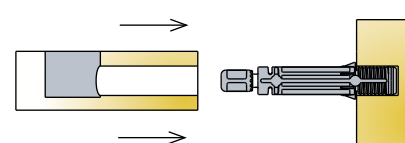

3. Assemble the panels

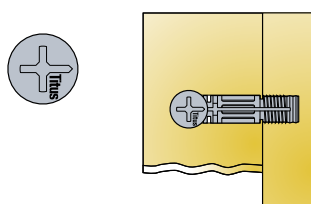

4. Tighten cam to lock dowel

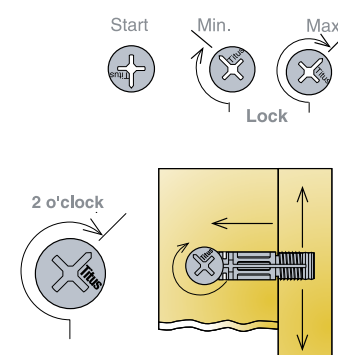

System 5 Cams and Dowels

Quickfit TL5 'Full Metal Jacket'

Effective performance in multiple wooden materials

- Smooth and noticeable locking at the 2 o'clock position guarantees:
- tight joints
 - always-right tightening at home assembly
 - strong and rigid cabinet construction

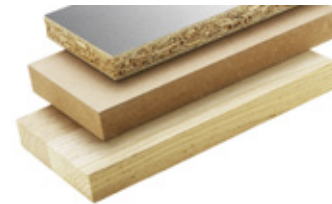

Strong and reliable joint

Expanding steel sleeve assures high resistance to torsion and pull-out.

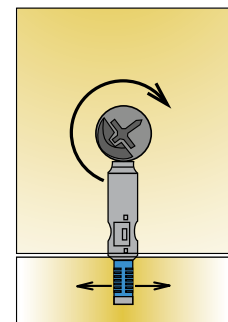

High drilling tolerances

An extended dowel head design works as a positive stop against the cam and provides an ETHC tolerance of min. +/-1mm

Fully tightened joint assured even at marginal inconsistencies of drilling and problems associated with the natural movement of wood panels.

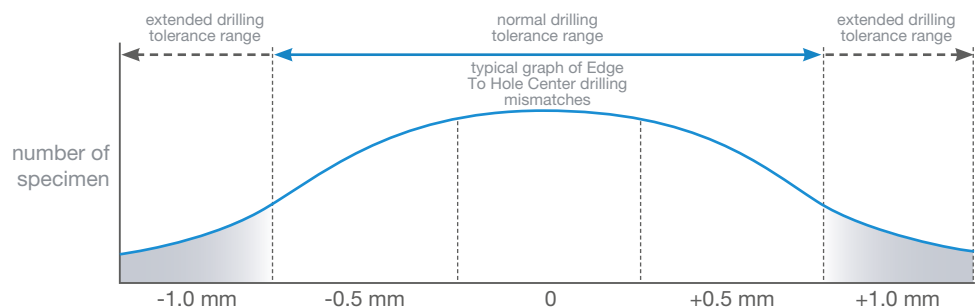
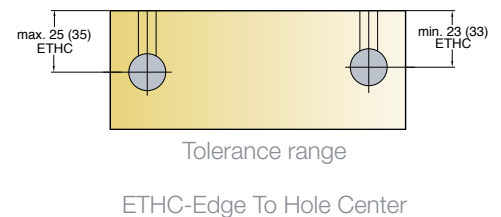

Shape of dowel sleeve

- Acts as a positive stop when inserted
- Ensures correct insertion depth



Tool-free insertion for Ø5mm dowel holes

Quickfit TL5 reliably engages the 5mm dowel hole. It enables the usage of tool-less Quickfit dowel insertion technology across a wide range of applications.

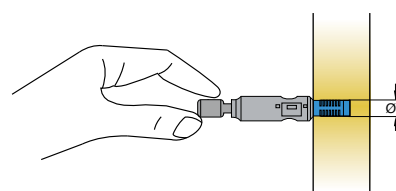

50% less time to assemble the cabinet at home

When edge inserted the dowel engages the cam and remains securely positioned until the boards are locked together.

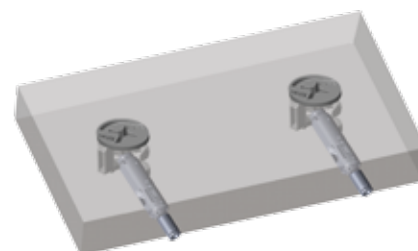

For maximum efficiency the insertion process can be automated using the Titus proprietary Lama FastFit machine.

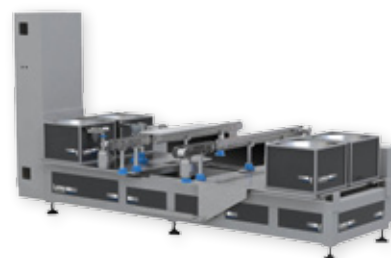

Fast and easy cabinet assembly at home.

CAF Quick & Easy

Consumer Assembly Friendliness

System 5 Cams and Dowels

Zinc+steel Combi Dowels

**Zinc+steel
technology for
optimal strength
and performance**

The Combi dowel combines steel and a small amount of zinc to ensure high precision and dimensional accuracy, essential to provide furniture manufacturers with the broadest possible range of drilling tolerances.

toroidal head form

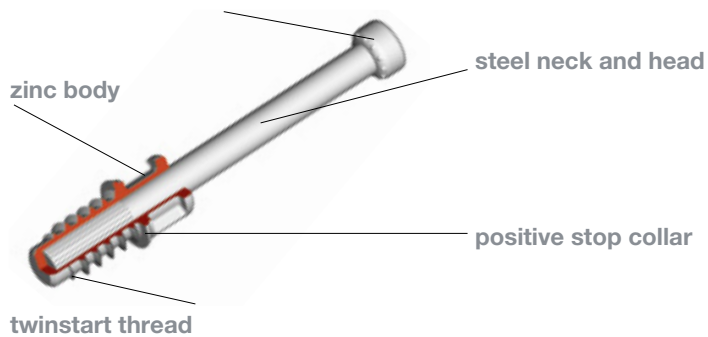

The steel neck and head provide better resistance to torsion and pull-out enabling a high performance joint

Zinc body:
Positive stop collar ensures correct insertion depth
Twinstart for faster and more stable insertion

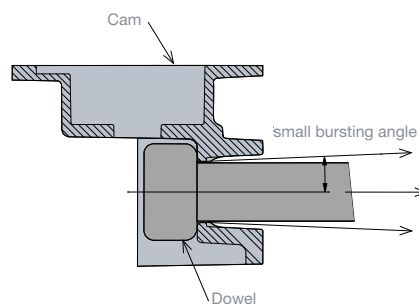

The toroidal dowel head form transfers the forces between cam and dowel more effectively resulting in a small cam bursting force.

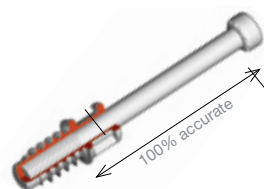

**100% dimensional accuracy
assured**

System 5

Quickfit TL5

'Full Metal Jacket'

- Tool-free insertion technology for Ø5mm dowel holes
- Drilling tolerances of +1/-1mm when edge inserted
- Expanding steel sleeve assures a strong joint, highly resistant to pull-out
- Functions in multiple wooden materials (chipboard, MDF, solid wood)
- Suitable for use with Cam5000

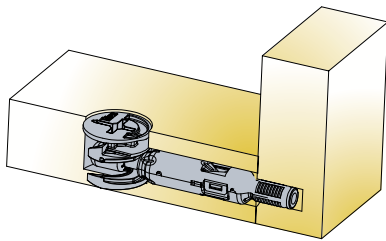

Technical and mounting details

Quickfit TL5 dowel

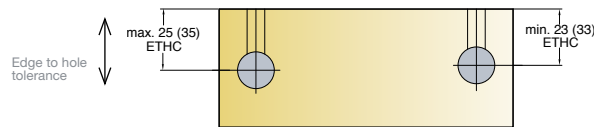
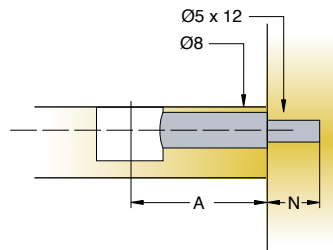
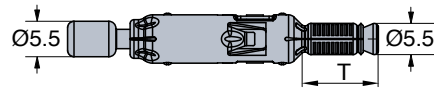

Tolerance range

A	N	T	Item number	TeraBlack
Drilling distance	Drilling depth	Drilling length		
34	12	11.5	09652 →	956
24	12	11.5	09651 →	956



To be used with Cam5000 only

 1000 Pcs

Made of steel

System 5

Cams and Dowels

Quickfit TL Dowels

- Available in Ø5mm and Ø8mm for panel-to-panel applications
- Suitable for use with all Ø15mm Cam2000, Cam3000, Cam3000 S and Cam5000 products
- 'Klix' locking feature provides a strong, vibration proof joint
- Highly tolerant in edge-inserted, TL4 also in face-inserted applications

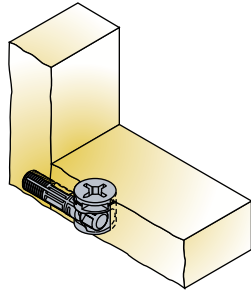

Technical and mounting details

Quickfit TL2

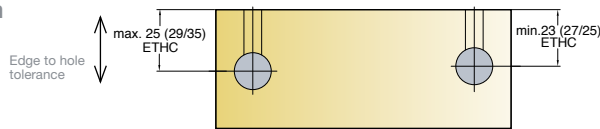
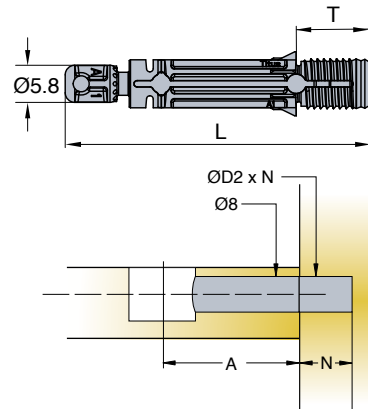

Tolerance range

2000 Pcs
1000 Pcs (05474)

Made of zinc, plastic

Quickfit TL4

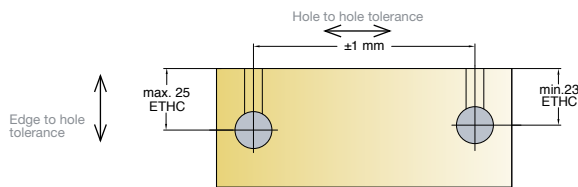
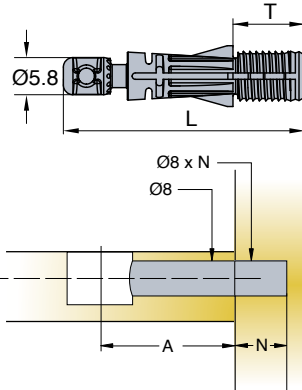

Tolerance range

3000 Pcs

Made of zinc, plastic

A	N	T	D2	Item number	Black	Dark grey
Drilling distance	Drilling depth	Thread length	Drilling diameter for dowel thread			
24	12	11.5	5	05453 →		880
34	12	11.5	5	05503 →		880
24	12	11.2	8	05366 →		880
28	12	11.2	8	05314 →		880
34	12	11.2	8	05474 →		880
24	12	11.2	8	05388 →	835	

System 5

Cams and Dowels

Quickfit Dowels

- Available in Ø5mm, Ø8mm and Ø10mm for panel-to-panel applications
- Suitable for use with all Ø15mm Cam2000, Cam3000, Cam3000 S and Cam5000 products
- 'Klix' locking feature provides a strong, vibration proof joint
- Depth stop collar for accurate insertion

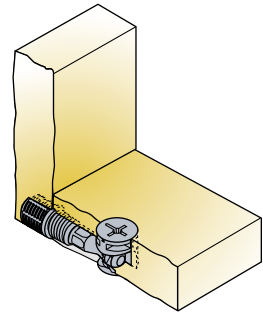

Technical and mounting details

Quickfit dowel
Ø8mm



1000 Pcs (05556,05552)
2000 Pcs (05563, 05554)

Made of zinc, plastic

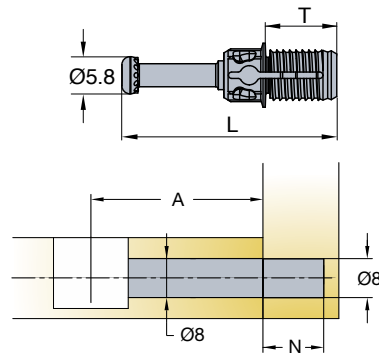

A	N	T	L	Item number	Dark grey
Drilling distance	Drilling depth	Drilling distance	Total length		
20	12	11.2	29.5	05556 →	880
24	12	11.2	33.5	05563 →	880
28	12	11.2	37.5	05552 →	880
34	12	11.2	43.5	05554 →	880

Quickfit dowel
Ø10mm



2000 Pcs

Made of zinc, plastic

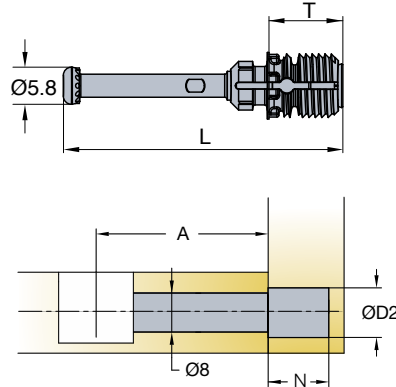

24	12	11.2	33	05052 →	880
34	12	11.2	43	05050 →	880

Quickfit dowel
For back-to-back application



1000 Pcs

Made of zinc, plastic

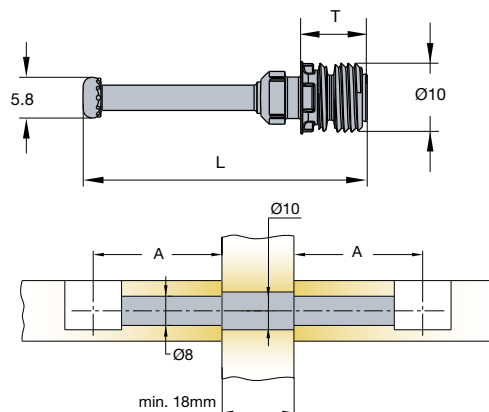

24	12	11.2	30.5	05270 →	880
34	12	11.2	40.5	05147 →	880

System 5

Cams and Dowels

Quickfit P2F Dowels

- The only product to enable standard panel drilling and connection of panel and hollow profile
- Available in Ø8mm for panel-to-hollow metal profile applications
- Suitable for use with all Ø15mm Cam2000, Cam3000, Cam3000 S and Cam5000 products
- 'Klix' locking feature provides a strong, vibration proof joint

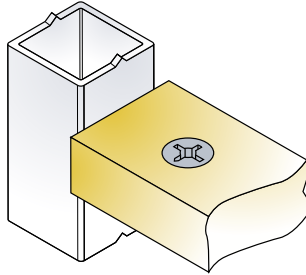

Technical and mounting details

Quickfit P2F

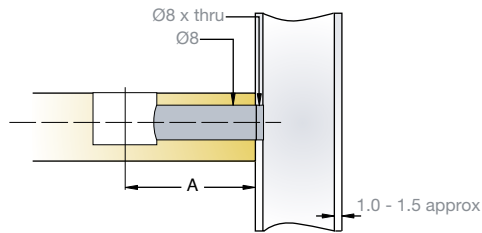
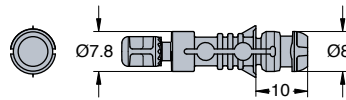

A

Drilling distance

Item number

Black

24

05414 →

835

 2000 Pcs

Made of zinc, plastic

System 5

Cams and Dowels

Combi Dowel

- High quality zinc-steel dowel with greater resistance to torsion and pull-out
- Suitable for use with all Ø12mm and Ø15mm Cam2000, Cam3000 S and Cam5000 products
- 'Klix' locking feature provides a strong, vibration proof joint
- Twinstart thread for faster and reliable insertion

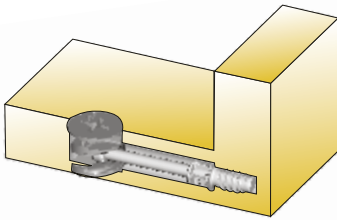

Technical and mounting details

A	N	X	Item number	Zinc
Drilling distance	Drilling depth	Thread length		

Combi dowel Ø5

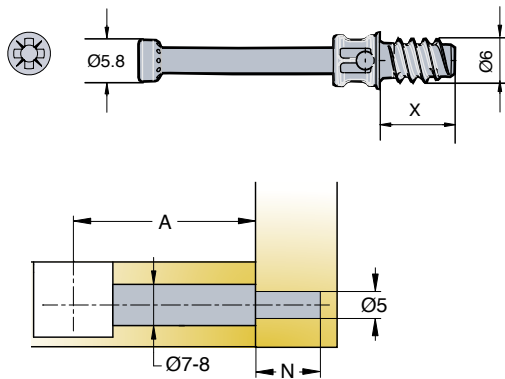

PH2 head
PH2 head
PH2 head

34	12	11	09435 →	885
28	10	9.5	09588 →	885
24	12	11	09443 →	885
24	9	8.5	09583 →	885
34	12	11	*09424 →	885
24	12	11	*09423 →	885
34	9	8.5	*09456 →	885

**American market only*

1000 Pcs
*2000 Pcs

Made of steel and zinc

Combi dowel M6

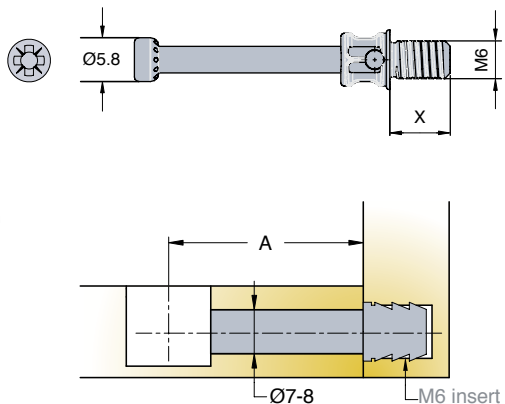

34		8	09592 →	885
34		10.5	09594 →	885

1000 Pcs

Made of steel and zinc



→ see page 1.59







→ see page 1.59

System 5

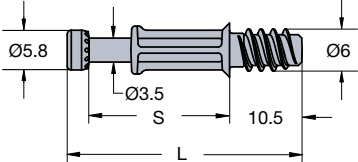
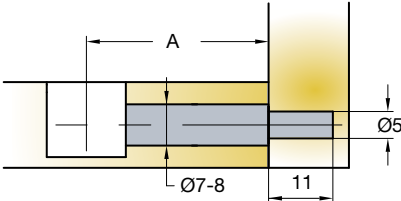
Cams and Dowels

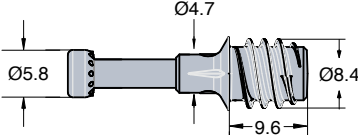
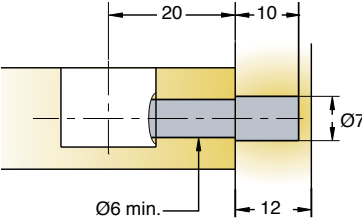
Combi Dowel

		S	L	A		
Technical and mounting details		Length	Total length	Drilling distance	Item number	Zinc
<p>Combi dowel Ø5 Full body</p>    <p>1000 Pcs</p> <p>Made of steel and zinc</p>		20.6	34.5	24	09597 →	885
<p>Combi dowel Ø7</p>    <p>1000 Pcs</p> <p>Made of steel and zinc</p>	<p>PH2 head</p> 			20	09430 →	885

Inserts
Made of plastic

→ see page 1.59

System 5

Cams and Dowels

Double-ended Dowel

- Available in Ø7mm
- Suitable for use with all Ø12mm and Ø15mm Cam2000, Cam3000, Cam3000 S and Cam5000
- No circlip for increased tolerance
- Available in a variety of lengths to suit most panel-to-panel applications

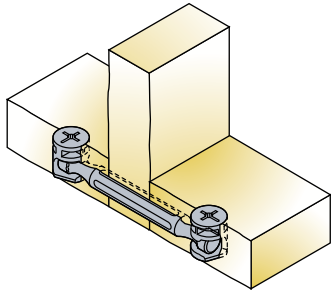

Technical and mounting details

Dowel without circlip

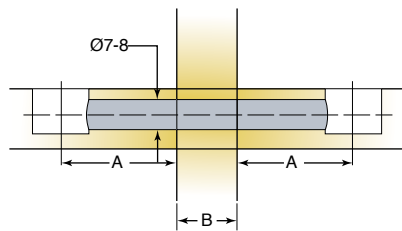
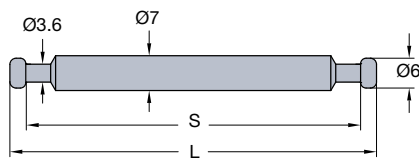

- 250 Pcs (05753)
- 500 Pcs (05857)
- 1000 Pcs (05929)

Made of steel

Dowel with circlip

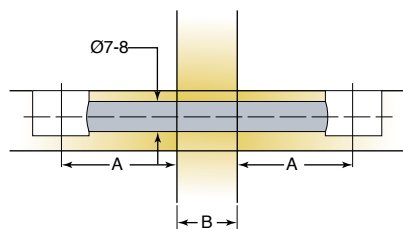
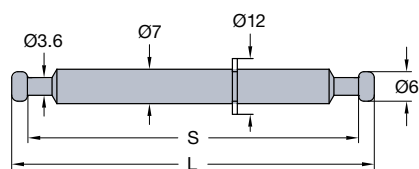

- 250 Pcs
- 500 Pcs (05775, 05774)

Made of steel

S	L	A	B	Item number	Zinc plated
Length	Total length	Drilling distance	Panel thickness		
41	47.4	24	0*	05929 →	883
61	67.4	34	0*	05757 →	883
77	83.4	34	16	05858 →	883
79	85.4	34	18	05859 →	883
80	86.4	34	19	05753 →	883
56	62.4	24	15	05592 →	883
57	63.4	24	16	05857 →	883
59	65.4	24	18	05380 →	883
60	66.4	24	19	05778 →	883
*B=0 → no panel required					

77	83.4	34	16	05752 →	883
79	85.4	34	18	05772 →	883
80	86.4	34	19	05751 →	883
57	63.4	24	16	05775 →	883
60	66.4	24	19	05774 →	883

System 5

Cams and Dowels

Angled Dowels

- Suitable for applications requiring angled joints
- Suitable for use with all Ø12mm and Ø15mm Cam2000, Cam3000, Cam3000 S and Cam5000
- Adjustable angle from 90° to 180°

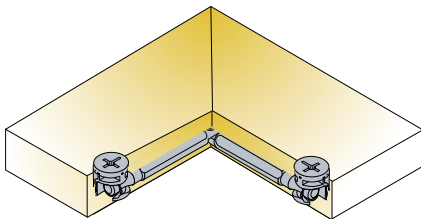

Technical and mounting details

Item number

Zinc plated

Angled dowel
180° fixed

05860 →

883

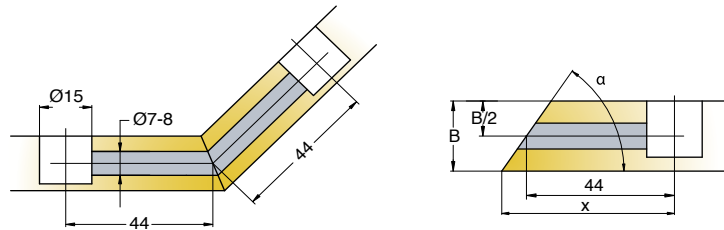

Distance x in mm

Q	20°	25°	30°	35°	40°	45°	50°	55°	60°	65°	67,5°	70°	75°	80°	85°		
13	61.9	57.9	55.3	53.5	51.7	50.5	49.5	48.6	47.8	47	46.7	46.4	45.7	45.1	44.6		
15	64.6	60.1	57	54.7	52.9	51.5	50.3	49.3	48.3	47.5	47.1	46.7	46	45.3	44.7		
16	66	61.2	57.9	55.4	53.5	52	50.7	49.6	48.6	47.7	47.3	46.9	46.1	45.4	44.7		
B	18	68.8	63.3	59.6	56.9	54.7	53	51.6	50.3	49.2	48.2	47.7	47.3	46.4	45.6	44.8	
	19	70.1	64.4	60.5	57.6	55.3	53.5	52	50.7	49.5	48.4	47.9	47.5	46.5	45.7	44.8	
	22	74.2	67.6	63.1	59.7	57.1	55	53.2	51.7	50.4	49.1	48.6	48	46.9	45.9	45	
	23	75.6	68.7	63.9	60.4	57.7	55.5	53.6	52.1	50.6	49.4	48.8	48.2	47.1	46	45	x

250 Pcs

Made of steel

Angled dowel
90° fixed

05282 →

883

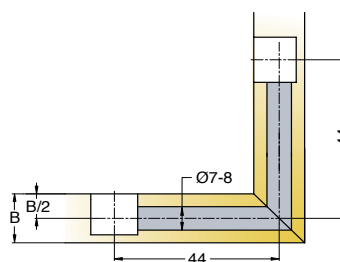

1000 Pcs

Made of steel

System 5

Cams and Dowels

End Dowels

- Available in a variety of head and length combinations to suit most end panel applications
- Suitable for use with all Ø12mm and Ø15mm Cam2000, Cam3000, Cam3000 S and Cam5000
- 'Klix' locking feature provides a strong, vibration proof joint
- Both 'mushroom' and countersunk headed versions available

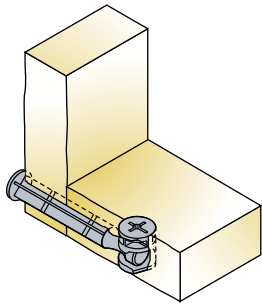

Technical and mounting details

Mushroom dowel

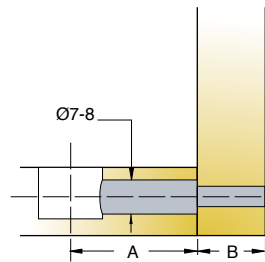
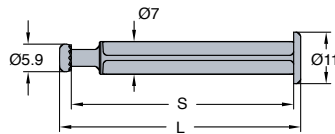

A	B	S	L	Item number	Zinc
Drilling distance	Panel thickness	Length	Total length		
24	16	36.5	40.5	05608 →	885
24	19	39.5	43.5	05609 →	885
34	16	46.5	50.5	05610 →	885
34	19	49.5	53.5	05611 →	885

500 Pcs (05610, 05611)
1000 Pcs (05608, 05609)

Made of zinc

System 5

Cams and Dowels

Ø15mm Cam5000

- Improved central shape for highly resistant joint
- Suitable for use with all Titus dowels
- 'Klix' locking feature provides a strong, vibration proof joint
- Cam retaining pips ensure that a cam is held in panel position prior to assembly

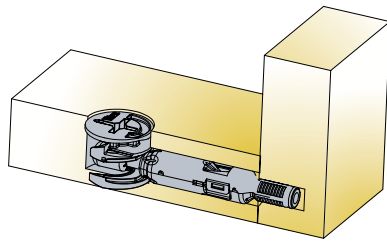

Technical and mounting details

B	D	e	h	Item number	Zinc
Panel thickness	Drilling depth	Drilling for dowel	Cam height		

Cam5000 cross drive

PZ2 drive

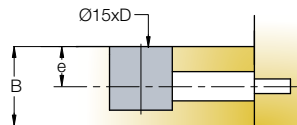
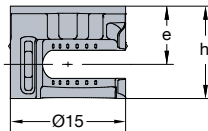

12/13	10.5	6 min	9.9	09695 →	885
15/16	12.5	7.5/8	11.9	09690 →	885

Use standard cover caps with pin=Ø4mm

1000 Pcs

Made of zinc

Cam5000 hexagonal drive

combined drive with HEX

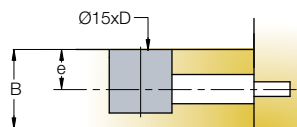
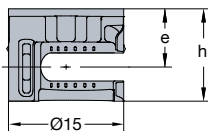

15/16	12.5	7.5/8	11.9	09699 →	885
18/19	14	9/9.5	13.2	09692 →	885

Use standard cover caps with pin=Ø4mm

Black available upon request

1000 Pcs

Made of zinc

System 5

Cams and Dowels

Ø15mm Cam3000 S

- Innovative design offers optimal performance with maximum cost effectiveness
- Suitable for use with Combi dowels, forged steel dowels and Quickfit dowels
- 'Klix' locking feature provides a strong, vibration proof joint
- Cam-retaining pins ensure that a cam is held in panel position prior to assembly

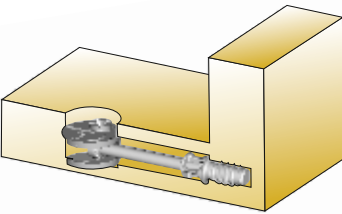

Technical and mounting details

B	D	e	Item number	Zinc	Zinc corrosi
Panel thickness	Drilling depth	Drilling for dowel			

Cam3000 S/15

PZ2 drive

15/16	12.5	7.5/8	09491 →	885	897
-------	------	-------	----------------	-----	-----

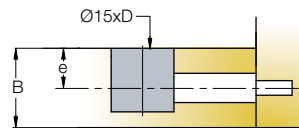
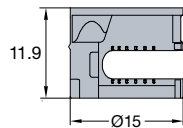

1000 Pcs

Made of zinc

Cam3000 S/12

PZ2 drive

12 min	9.5 min	min 6	*09406 →	885	897
--------	---------	-------	-----------------	-----	-----

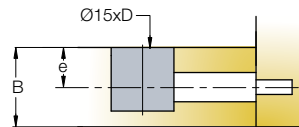
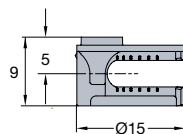

* European market only

2000 Pcs

Made of zinc

Cam3000 S/12

Philips PH2 drive

12 min	9.5 min	min 6	*09631 →	885	
--------	---------	-------	-----------------	-----	--

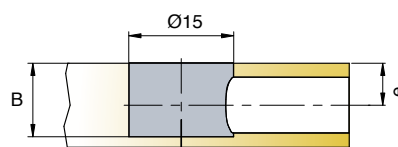
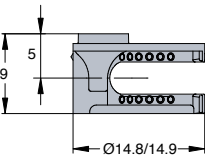

* American market only

1000 Pcs

Made of zinc



Cover caps 09630
Made of plastic

System 5

Cams and Dowels

Ø15mm Cam3000

- Its optimised shape provides a more efficient cam profile with smooth tightening action and greater dowel pull-up
- Suitable for use with Combi dowels, forged steel dowels, Quickfit dowels and Quickfit TL dowels
- 'Klix' locking feature provides a strong, vibration proof joint
- Cam-retaining pips ensure that a cam is held in panel position prior to assembly

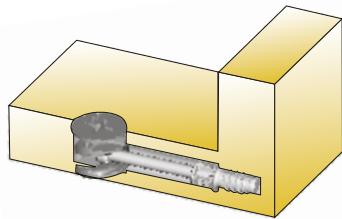

Technical and mounting details

B	D	e	h		
Panel thickness	Drilling depth	Drilling for dowel	Cam height	Item number	Zinc
12/13	10.5	6 min	9.9	09495 →	885
15/16	12.5	7.5-8	11.9	09533 →	885

Cam3000 cross drive

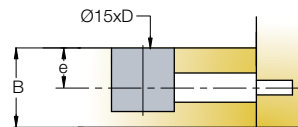
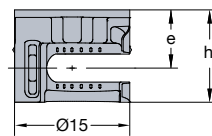

Black available upon request

1000 Pcs

Made of zinc

Cam3000 hexagonal drive



combined drive with HEX

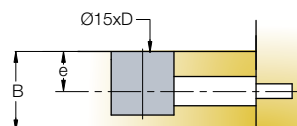
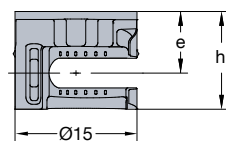

15/16	12.5	7.5-8	11.9	09537 →	885
18/19	14	9-9.5	13.2	09536 →	885

Use standard cover caps with pin=Ø4mm

Black available upon request

1000 Pcs

Made of zinc

System 5

Cams and Dowels

Ø15mm Cam2000

- Available in a variety of head, drive recess and board thickness versions to suit most applications
- Suitable for use with all Titus dowels
- 'Klix' locking feature provides a strong, vibration proof joint
- Linear cam profile results in smooth, easy cam rotation and dowel pull-up

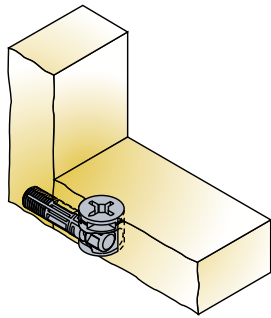

Technical and mounting details

B	D	e			
Panel thickness	Drilling depth	Drilling for dowel	Item number	Nickel	Zinc

Cam2000
Ø15

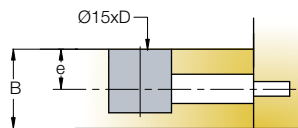
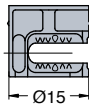

12/13	10min	6-6.5	*05587 →	847	885
-------	-------	-------	----------	-----	-----



15/16	12.7	7.5-8	05654 →	847	885
-------	------	-------	---------	-----	-----

22/23	16	11-11.5	05657 →	847	885
-------	----	---------	---------	-----	-----

25/26	17.9	12.5-13	05676 →	847	885
-------	------	---------	---------	-----	-----

28/29	19.4	14-15.5	05678 →	847	885
-------	------	---------	---------	-----	-----

Other finishes on request

*Ultraflat - specially designed for thin panels
(does not work with TL dowels)

500 Pcs (05676, 05678)
1000 Pcs

Made of zinc

Cam2000
Ø15 headed

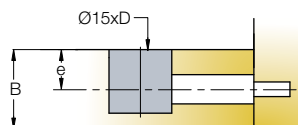
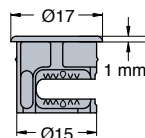

12	10min	6	*05586 →	847	885
----	-------	---	----------	-----	-----



13	10.9min	6.5	05652 →	847	885
----	---------	-----	---------	-----	-----

16	12.9	8	05658 →	847	885
----	------	---	---------	-----	-----

19	13	9.5	05659 →	847	885
----	----	-----	---------	-----	-----

23	14.5	11.5	05675 →	847	885
----	------	------	---------	-----	-----

26	16.5	13	05677 →	847	885
----	------	----	---------	-----	-----

29	19.4	14.5	05679 →	847	885
----	------	------	---------	-----	-----

Other finishes on request

*Ultraflat - specially designed for thin panels
(does not work with TL dowels)

500 Pcs (05675, 05677, 05679)
1000 Pcs

Made of zinc



Cover caps for Ø15 cams
Made of plastic

→ see page 1.65

System 5

Cams and Dowels

Ø12mm Cam2000

- Suitable for all Titus screw-in dowels
- Available in a variety of head, drive recess and board thickness versions to suit most applications
- Particularly suited to drawer front attachment applications
- 'Klix' locking feature provides a strong, vibration proof joint
- Linear cam profile results in smooth, easy cam rotation and dowel pull-up

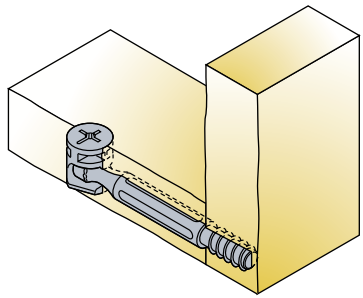

Technical and mounting details

B	D	e	Item number	Black painting plate	Nickel plated	Zinc	Corrosil zinc
Panel thickness	Drilling depth	Drilling for dowel					
12/13	10 min	6-6.5	05575 →	838	847	885	897
15/16	12	7.5-8	05578 →			885	
18/19	13 min	9-9.5	05580 →			885	
<i>Other finishes on request</i>							

Cam2000
Ø12

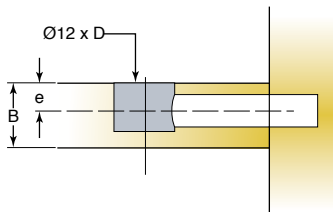
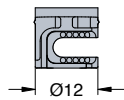

2000 Pcs

Made of zinc

Cam2000
Ø12 headed



12	9.2 min	5.25	05574 →	838	847	885	897
12	10 min	6	05576 →			885	
16	12.5	8	05579 →			885	
<i>Other finishes on request</i>							

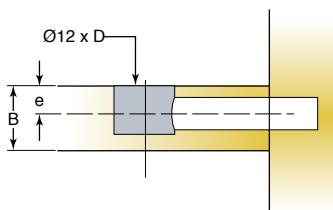
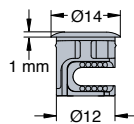

1000 Pcs
2000 Pcs (05576)

Made of zinc







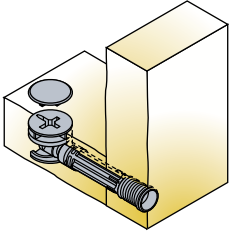
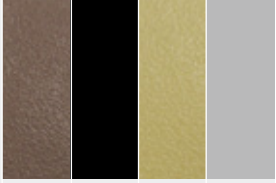

Cover caps for Ø12 cams
Made of plastic

→ see page 1.65

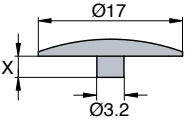
System 5 Cover Caps

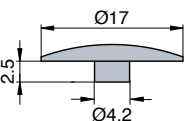
- Available in a variety of colours
- Suitable for use with both pozi and hex cam drive features
- Suitable for use with various diameter cams
- Both domed and flat versions available

 Technical and mounting details		X					
			Pin length	Item number	Dark brown	Black	Light brown
Cover cap Ø17 		3.3	*01029 →	834	835	867	882
		2.5	277-4355 →	370	390	330	380
 1000 Pcs Made of plastic		*American market only Other colours on request Suitable for cams with Pozi 2 recess					
Cover cap Ø17 			277-4225 →	370	390	330	380
		Other colours on request Suitable for cams with Hex recess					
 1000 Pcs Made of plastic							