

System 5

Cams and Dowels

Ø15mm Cam5000

- Improved central shape for highly resistant joint
- Suitable for use with all Titus dowels
- 'Klix' locking feature provides a strong, vibration proof joint
- Cam retaining pips ensure that a cam is held in panel position prior to assembly

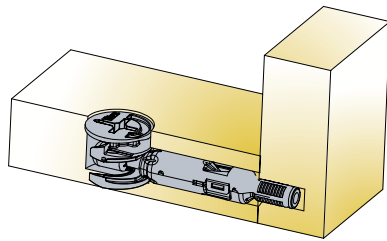

Technical and mounting details

B	D	e	h	Item number	Zinc
Panel thickness	Drilling depth	Drilling for dowel	Cam height		

Cam5000 cross drive

PZ2 drive

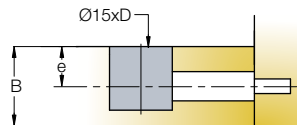
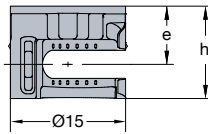

12/13	10.5	6 min	9.9	09695 →	885
15/16	12.5	7.5/8	11.9	09690 →	885

Use standard cover caps with pin=Ø4mm

1000 Pcs

Made of zinc

Cam5000 hexagonal drive

combined drive with HEX

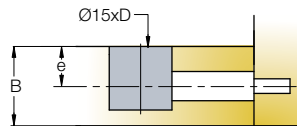
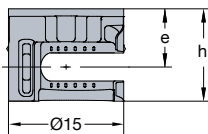

15/16	12.5	7.5/8	11.9	09699 →	885
18/19	14	9/9.5	13.2	09692 →	885

Use standard cover caps with pin=Ø4mm

Black available upon request

1000 Pcs

Made of zinc